

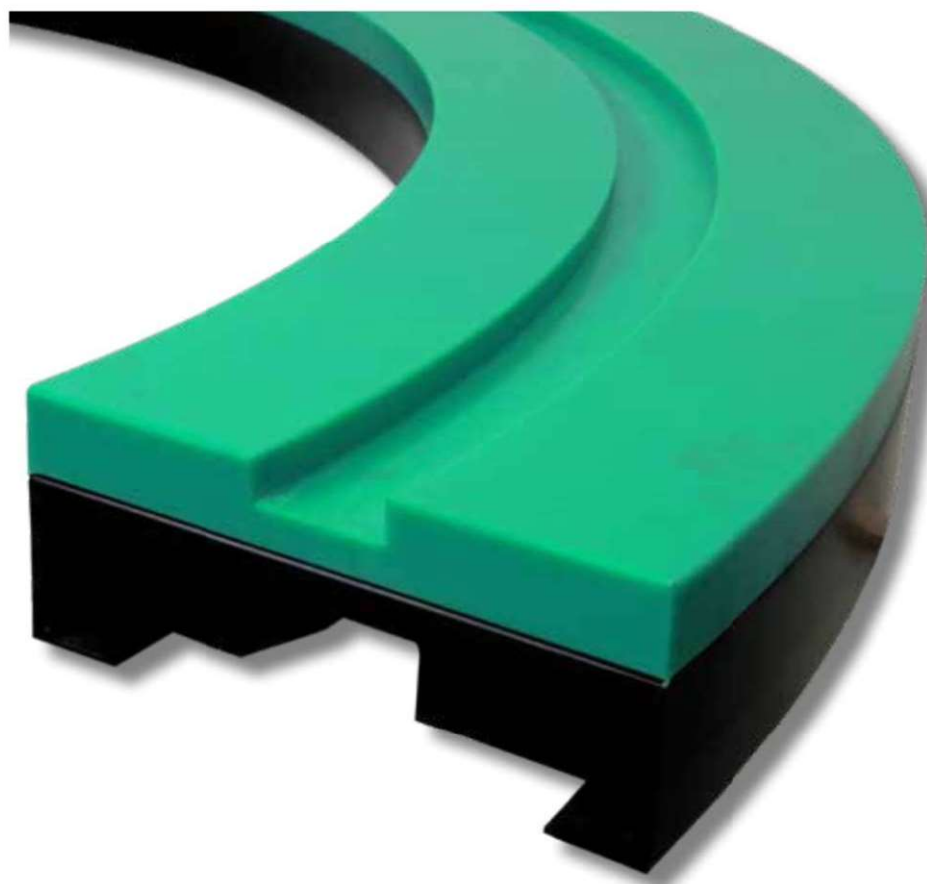

***FliteTop*® Matveyor®**

Magnetic Curves



Magnetic curves are a combined system for both steel and plastic chains.

Two magnets, integrated underneath the track and connected by a steel plate, creating a strong magnetic field that results in an even force keeping down steel chains as well as plastic chains with steel pins running in the curve.

The position of the magnets has been carefully studied in order to get the ideal distribution of the magnetic field, with the following results:



- No chain pulsation effect when the chain is being pulled through the curve.
- Chains perfectly flat in curve without tilting

The REGINA magnetic curve consists of mainly N. 3 parts:

- 1 Machined upper plastic part of the curve, normally supplied with the standard SUPREME-A material which is a virgin UHMWPE (about 7 millions gr/mole) with an optimum wear resistance.
- 2 Machined return part of the curve, supplied in UHMWPE material with 4 millions gr/mole which is suitable even for the most demanding applications. This part is jointed to the upper part by stainless steel self-tapping screws.
- 3 Return guide shoe, made in UHMWPE material with 4 millions gr/mole, to bring the chain at the right height to enter the return part of the curve.



For special applications involving very high speeds and reduced lubrication conditions new e-SLIDE and SUPREME-S materials can be used to guarantee higher PV (Pressure-Velocity) loads according to the application needs.

CURVE MATERIAL	FEATURES	CHAIN TYPE	APPLICATIONS
 STANDARD MATERIAL	Ultra high molecular weight polyethylene (about 7 million gr/mole) with good wear resistance and low coefficient of friction.	For steel and plastic chains.	Ideal in low/medium speed applications in dry or lubricated conditions.
	New ultimate Ultra High Molecular Weight Polyethylene (molecular density of 9.000.000 g/mol). Thanks to special lube additives compounded with the material, provides superior sliding performance and excellent wear resistance of chains and belts in high-speeds and dry running application.	For steel and plastic chains.	Suitable in high speed applications in dry or reduced lubricated conditions.
	Special high grade and oil-filled polyamide with superior abrasion resistance and extremely high PV limit. Dry running only.	For plastic chains.	Suitable in high speed applications in dry running conditions.

e-SLIDE FEATURES AND BENEFITS

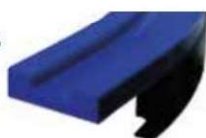

COF between chain and wearstrips/curves

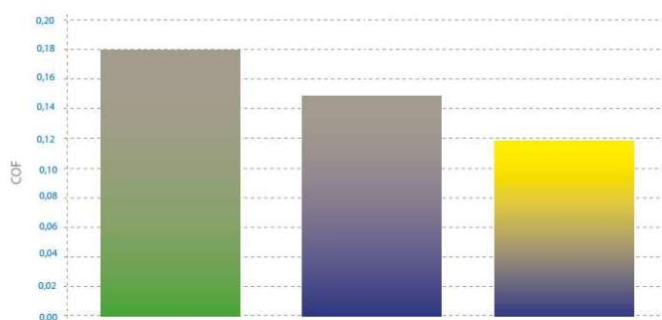

- UP chain + UHMWPE wearstrips/curves
- UP chain + e-SLIDE wearstrips/curves
- e-F.A.S.T. chain + e-SLIDE wearstrips/curves

Chain pull trend in a sideflexing conveyor system

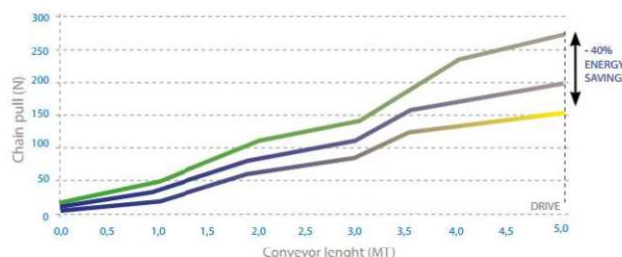

- UP chain + UHMWPE wearstrips/curves
- UP chain + e-SLIDE wearstrips/curves
- e-F.A.S.T. chain + e-SLIDE wearstrips/curves

SUPPLY INFORMATION

REGINA magnetic curves are supplied as follow:

- The upper and return part are connected by stainless steel self-tapping screws $\varnothing 4$ mm.

- All of REGINA curves are supplied with the return guide shoe equipped with N.4 brass threaded inserts M8 already assembled.

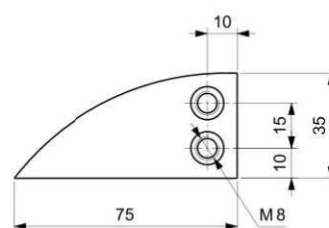
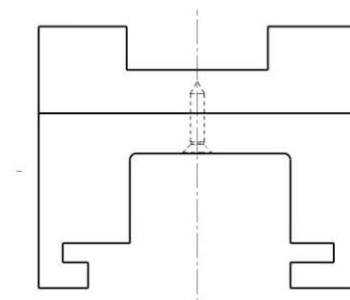

INSTALLATION OF THE MAGNETIC CURVES

REGINA magnetic curves can be installed on the conveyor in the two following ways:

- 1) Fixing the outer and the inner side of the curve (upper and return part jointed together) to the conveyor frame. In this case the curve is installed with the upper and return part connected as supplied by REGINA and it is fixed to the conveyor making lateral holes on the return part of the curve and using brass threaded inserts M10. These inserts can be **ORDERED SEPARATELY** with the P/N I-SCTBM10 (component **NOT supplied** with the curves).

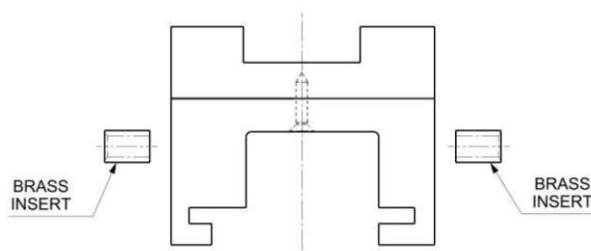

- 2) The upper and return part of the curve can be installed **separately** on the conveyor. In this case the curve, which is supplied with the upper and return part connected with stainless steel self-tapping screws, must be disassembled and fixed to a conveyor crossbar using the holes present on both parts of the curve. The screws to fix the upper and lower part of the curve to the crossbar must have a proper length depending on the conveyor structure. Those screws are **NOT** supplied by REGINA.

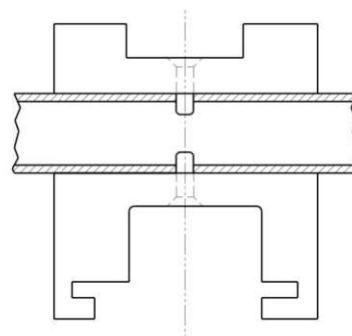

REFERENCE TABLE

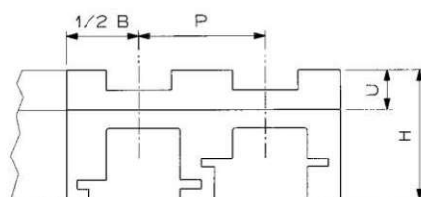
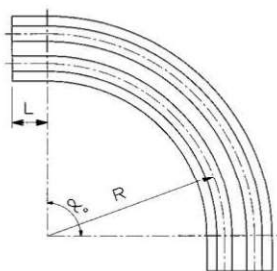

CHAIN TYPE				RADIUS ⁽¹⁾ R mm	TRANSVERSAL PITCH P mm	BASIC WIDTH B mm	INFEED LENGHT L mm	UPPER PART HEIGHT U mm	TOTAL HEIGHT H mm	VERSION NUMBER	SEE PAGE
SERIES	WIDTH	THICKNESS mm	HINGE WIDTH mm								
981M PHD 981M PHDG 981M	3 1/4" 83.8 mm	3	42	500	85	100	0	27	82 ⁽²⁾ /90 ⁽³⁾	F 01	281
						100	100		90	F 02	282
						111	100		90	F 03	283
						89	100		82	F 04	284
						100	125		82	F 05	285
880M RG		4		680	-	100	100		82	F 06	286
				750	85	100	100		82 ⁽²⁾ /90 ⁽³⁾	F 07	287
				860	-	100	125		82	F 08	288
				1000	-	100	0		82	F 09	289
				1000	85	111	100		90	F 10	290
981M PHD 981M	4 1/2"	3	42	500	120	129	125	27	90	F 11	291
				610	120	129	125		90	F 12	292
					117	129	0		90	F 13	293
981M PHD 981M PHDG 981M	7 1/2"	3	42	610	196	214	125	27	90	F 14	294
				860	-	214	0		82	F 15	295
				1000	-	214	0		82	F 16	296
PHD 9857M PHDG 9857M 882M HFX 882M	7 1/2"	3 4,8	57	610 ⁽⁴⁾	195	200	100	32	87 ⁽²⁾ /95 ⁽³⁾	H 01	297
				750	195	200	100		87 ⁽²⁾ /95 ⁽³⁾	H 02	298
				860	-	214	0		87	H 03	299
				1000	-	214	0		87	H 04	300
882M HFX 882M	10" 12"	4,8	57	860	-	290	0	32	87	H 05	301
	340					H 06			302		
LBP 882M	7 1/2" 10" 12"	4,8	57	860	-	214	0	32		L 01	303
	290					95			L 02	304	
	340								L 03	305	
782M 783M	83.8 mm	8,7	42	500	85	100	0	27	82 ⁽²⁾ /90 ⁽³⁾	M 01	306
						100	100		90	M 02	307
						111	100		90	M 03	308
				750	85	100	100		90	M 04	309
						111	100		90	M 05	310
						1000	85		100	0	90
793M	83.8 mm	12,7	42	500	85	100	0	27	82 ⁽²⁾ /90 ⁽³⁾	U 01	312
						100	100		90	U 02	313
						111	100		90	U 03	314
				750	85	100	100		90	U 04	315
				1000	85	100	0		90	U 05	316
793M	4 1/2"	12,7	42	500	120	129	125	27	90	U 06	317

⁽¹⁾ First track is intended.

⁽²⁾ For curves with one track.

⁽³⁾ For multi tracks curves.

⁽⁴⁾ 882M and HFX 882M series only.

VERSION F 01

SUITABLE FOR CHAINS:

- 981M K 3¼ (See page 38)
- 981M K 83,8 (See page 38)
- PHD 981M K 3¼ (See page 38)
- PHD 981M K 83,8 (See page 38)
- PHDG 981M K 3¼ (See page 46)
- 880M RG K 3¼ (See page 57)
- 880M RG K 83,8 (See page 57)

RADIUS	BASIC WIDTH	TRANSVERSAL PITCH	INFEED/OUTFEED LENGTH
mm	mm	mm	mm
500	100	85	-



Single track

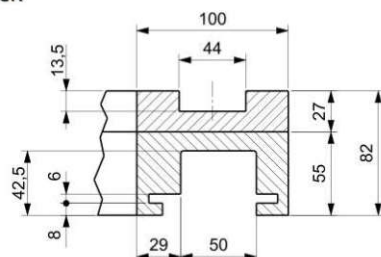

Multi track

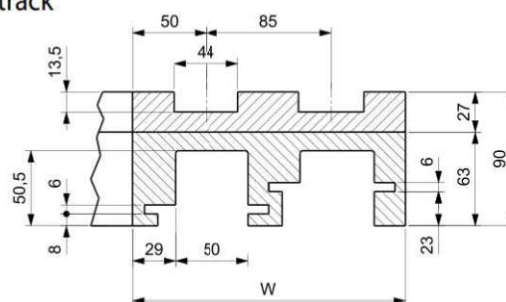

Radius

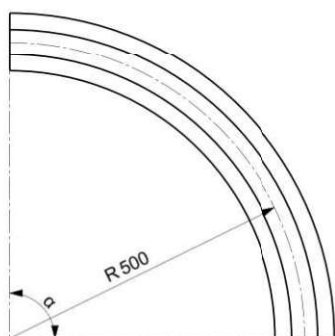

Return guide shoe

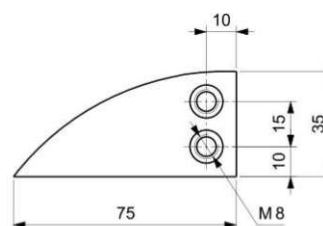

On request, Upper part is available in Self-Lubricating UHMWPE & Oil-filled PA.



PART NUMBER IDENTIFICATION			
CURVES	SUPREME -A	NEW e-SLIDE	SUPREME -S
UPPER PART MATERIAL	UHMWPE	High performance Self-lubricating UHMWPE	Oil-filled PA
PART NUMBERS	See table below	Replace "MF" with "MFE" Example: 2 tracks, 90° curve angle, P/N: MFE02AAY/110	Replace "MF" with "MFP" Example: 2 tracks, 90° curve angle, P/N: MFP02AAY/110



Curve installation
see page 279



Curve material
see page 278

N. OF TRACKS	TOTAL WIDTH W mm	PART NUMBER					
		Curve angle alpha					
		15°	30°	45°	60°	75°	90°
1	100	MF01AFX/100	MF01AEX/100	MF01ACX/100	MF01ABX/100	MF01ALX/100	MF01AAX/100
2	185	MF02AFY/110	MF02AEY/110	MF02ACY/110	MF02ABY/110	MF02ALY/110	MF02AAY/110
3	270	MF03AFY/110	MF03AEY/110	MF03ACY/110	MF03ABY/110	MF03ALY/110	MF03AAY/110
4	355	MF04AFY/110	MF04AEY/110	MF04ACY/110	MF04ABY/110	MF04ALY/110	MF04AAY/110
5	440	MF05AFY/110	MF05AEY/110	MF05ACY/110	MF05ABY/110	MF05ALY/110	MF05AAY/110
6	525	MF06AFY/110	MF06AEY/110	MF06ACY/110	MF06ABY/110	MF06ALY/110	MF06AAY/110

NOTE: For custom requests with dimensions different from the standard, please refer to page 318.

VERSION F 02

SUITABLE FOR CHAINS:

- 981M K 3¼ (See page 38)
- 981M K 83,8 (See page 38)
- PHD 981M K 3¼ (See page 38)
- PHD 981M K 83,8 (See page 38)
- PHDG 981M K 3¼ (See page 46)
- 880M RG K 3¼ (See page 57)
- 880M RG K 83,8 (See page 57)

RADIUS	BASIC WIDTH	TRANSVERSAL PITCH	INFEED/OUTFEED LENGTH
mm	mm	mm	mm
500	100	85	100



Single track

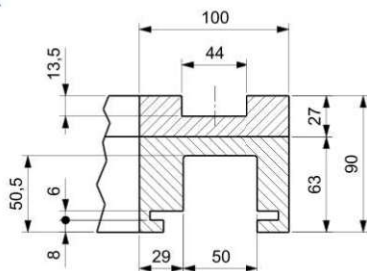

Multi track

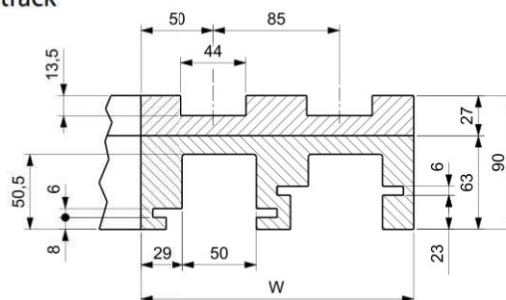

Radius

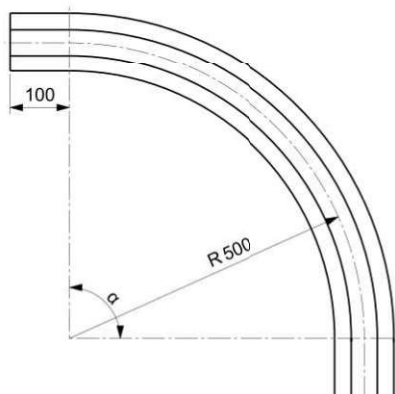

Return guide shoe

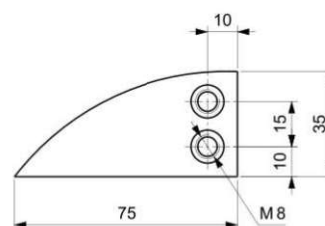

On request, Upper part is available in Self-Lubricating UHMWPE & Oil-filled PA.



PART NUMBER IDENTIFICATION

CURVES	SUPREME -A	NEW e-SLIDE	SUPREME -S
UPPER PART MATERIAL	UHMWPE	High performance Self-lubricating UHMWPE	Oil-filled PA
PART NUMBERS	See table below	Replace "MF" with "MFE" Example: 2 tracks, 90° curve angle, P/N: MFE02AAY/111	Replace "MF" with "MFP" Example: 2 tracks, 90° curve angle, P/N: MFP02AAY/111

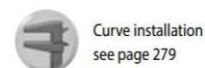

Curve installation
see page 279



Curve material
see page 278

N. OF TRACKS	TOTAL WIDTH W mm	PART NUMBER					
		Curve angle α					
		15°	30°	45°	60°	75°	90°
1	100	MF01AFY/101	MF01AEY/101	MF01ACY/101	MF01ABY/101	MF01ALY/101	MF01AAY/101
2	185	MF02AFY/111	MF02AEY/111	MF02ACY/111	MF02ABY/111	MF02ALY/111	MF02AAY/111
3	270	MF03AFY/111	MF03AEY/111	MF03ACY/111	MF03ABY/111	MF03ALY/111	MF03AAY/111
4	355	MF04AFY/111	MF04AEY/111	MF04ACY/111	MF04ABY/111	MF04ALY/111	MF04AAY/111
5	440	MF05AFY/111	MF05AEY/111	MF05ACY/111	MF05ABY/111	MF05ALY/111	MF05AAY/111
6	525	MF06AFY/111	MF06AEY/111	MF06ACY/111	MF06ABY/111	MF06ALY/111	MF06AAY/111

NOTE: For custom requests with dimensions different from the standard, please refer to page 318.

VERSION F 03

SUITABLE FOR CHAINS:

- 981M K 3¼ (See page 38)
- 981M K 83,8 (See page 38)
- PHD 981M K 3¼ (See page 38)
- PHD 981M K 83,8 (See page 38)
- PHDG 981M K 3¼ (See page 46)
- 880M RG K 3¼ (See page 57)
- 880M RG K 83,8 (See page 57)

RADIUS	BASIC WIDTH	TRANSVERSAL PITCH	INFEED/OUTFEED LENGTH
mm	mm	mm	mm
500	111	85	100



Single track

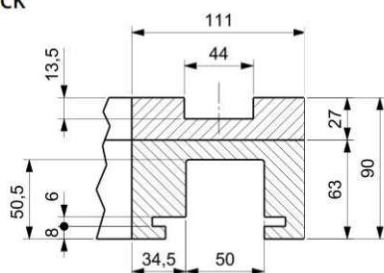

Multi track

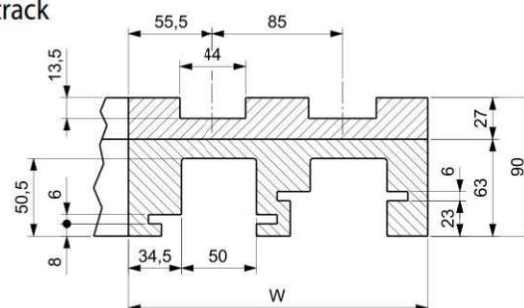

Radius

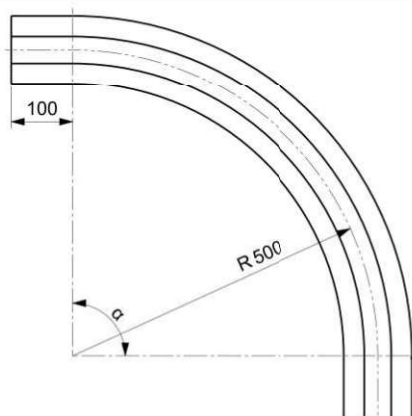

Return guide shoe

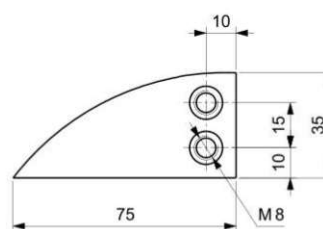

On request, Upper part is available in Self-Lubricating UHMWPE & Oil-filled PA.



PART NUMBER IDENTIFICATION

CURVES	SUPREME - A	NEW e-SLIDE	SUPREME - S
UPPER PART MATERIAL	UHMWPE	High performance Self-lubricating UHMWPE	Oil-filled PA
PART NUMBERS	See table below	Replace "MF" with "MFE" Example: 2 tracks, 90° curve angle, P/N: MFE02AAAY/311	Replace "MF" with "MFP" Example: 2 tracks, 90° curve angle, P/N: MFP02AAAY/311



Curve installation
see page 279



Curve material
see page 278

N. OF TRACKS	TOTAL WIDTH W mm	PART NUMBER					
		Curve angle α					
		15°	30°	45°	60°	75°	90°
1	111	MF01AFY/301	MF01AEY/301	MF01ACY/301	MF01ABY/301	MF01ALY/301	MF01AAY/301
2	196	MF02AFY/311	MF02AEY/311	MF02ACY/311	MF02ABY/311	MF02ALY/311	MF02AAY/311
3	281	MF03AFY/311	MF03AEY/311	MF03ACY/311	MF03ABY/311	MF03ALY/311	MF03AAY/311
4	366	MF04AFY/311	MF04AEY/311	MF04ACY/311	MF04ABY/311	MF04ALY/311	MF04AAY/311
5	451	MF05AFY/311	MF05AEY/311	MF05ACY/311	MF05ABY/311	MF05ALY/311	MF05AAY/311
6	536	MF06AFY/311	MF06AEY/311	MF06ACY/311	MF06ABY/311	MF06ALY/311	MF06AAY/311

NOTE: For custom requests with dimensions different from the standard, please refer to page 318.

VERSION F 04

SUITABLE FOR CHAINS:

- 981M K 3¼ (See page 38)
- 981M K 83,8 (See page 38)
- PHD 981M K 3¼ (See page 38)
- PHD 981M K 83,8 (See page 38)
- PHDG 981M K 3¼ (See page 46)
- 880M RG K 3¼ (See page 57)
- 880M RG K 83,8 (See page 57)

RADIUS	BASIC WIDTH	TRANSVERSAL PITCH	INFEED/OUTFEED LENGTH
mm	mm	mm	mm
500	100	89	125



Single track

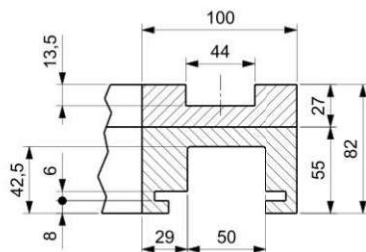

Multi track

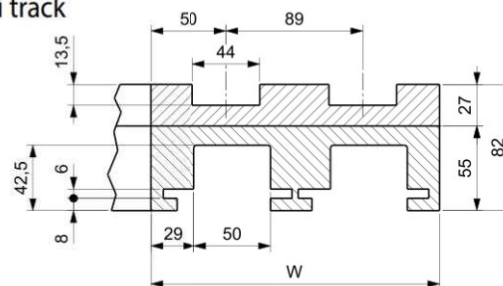

Radius

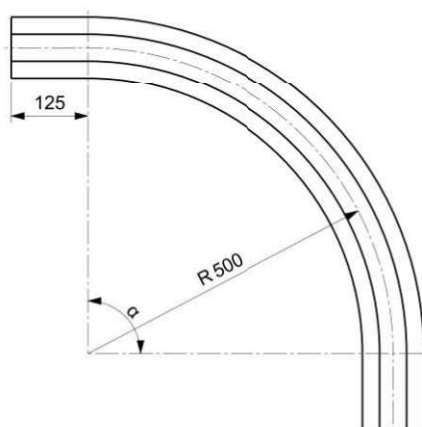

Return guide shoe

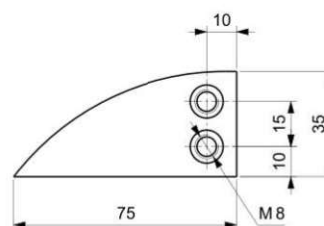

On request, Upper part is available in Self-Lubricating UHMWPE & Oil-filled PA.



PART NUMBER IDENTIFICATION

CURVES	SUPREME - A	NEW e-SLIDE	SUPREME - S
UPPER PART MATERIAL	UHMWPE	High performance Self-lubricating UHMWPE	Oil-filled PA
PART NUMBERS	See table below	Replace "MF" with "MFE" Example: 2 tracks, 90° curve angle, P/N: MFE02AAX/122	Replace "MF" with "MFP" Example: 2 tracks, 90° curve angle, P/N: MFP02AAX/122

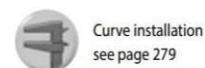

Curve installation see page 279



Curve material see page 278

N. OF TRACKS	TOTAL WIDTH W mm	PART NUMBER					
		Curve angle α					
		15°	30°	45°	60°	75°	90°
1	100	MF01AFX/102	MF01AEX/102	MF01ACX/102	MF01ABX/102	MF01ALX/102	MF01AAX/102
2	189	MF02AFX/122	MF02AEX/122	MF02ACX/122	MF02ABX/122	MF02ALX/122	MF02AAX/122
3	278	MF03AFX/122	MF03AEX/122	MF03ACX/122	MF03ABX/122	MF03ALX/122	MF03AAX/122
4	367	MF04AFX/122	MF04AEX/122	MF04ACX/122	MF04ABX/122	MF04ALX/122	MF04AAX/122
5	456	MF05AFX/122	MF05AEX/122	MF05ACX/122	MF05ABX/122	MF05ALX/122	MF05AAX/122
6	545	MF06AFX/122	MF06AEX/122	MF06ACX/122	MF06ABX/122	MF06ALX/122	MF06AAX/122

NOTE: For custom requests with dimensions different from the standard, please refer to page 318.

VERSION F 05

SUITABLE FOR CHAINS:

- 981M K 3¼ (See page 38)
- 981M K 83,8 (See page 38)
- PHD 981M K 3¼ (See page 38)
- PHD 981M K 83,8 (See page 38)
- PHDG 981M K 3¼ (See page 46)
- 880M RG K 3¼ (See page 57)
- 880M RG K 83,8 (See page 57)

RADIUS	BASIC WIDTH	TRANSVERSAL PITCH	INFEED/OUTFEED LENGTH
mm	mm	mm	mm
680	100	Single track	100



Single track

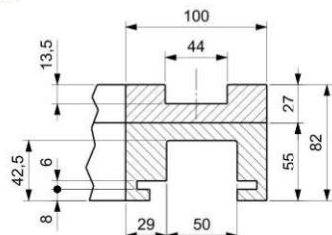

Radius

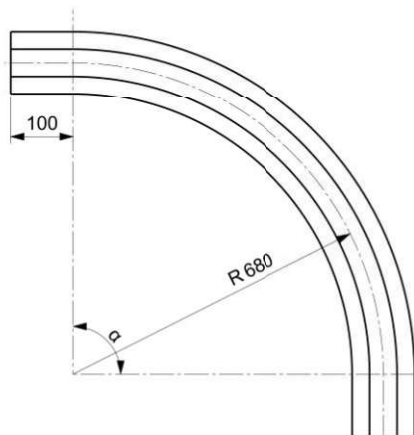

Return guide shoe

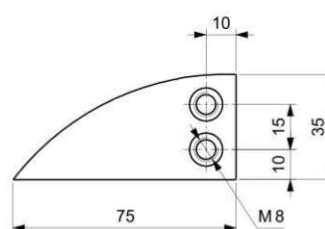

On request, Upper part is available in Self-Lubricating UHMWPE & Oil-filled PA.



PART NUMBER IDENTIFICATION			
CURVES	SUPREME -A	NEW <i>Q-SLIDE</i>	SUPREME -S
UPPER PART MATERIAL	UHMWPE	High performance Self-lubricating UHMWPE	Oil-filled PA
PART NUMBERS	See table below	Replace "MF" with "MFE" Example: 1 track, 90° curve angle, P/N: MFE01DAX/101	Replace "MF" with "MFP" Example: 1 track, 90° curve angle, P/N: MFP01DAX/101



Curve installation
see page 279



Curve material
see page 278

N. OF TRACKS	TOTAL WIDTH W mm	PART NUMBER					
		Curve angle α					
		15°	30°	45°	60°	75°	90°
1	100	MF01DFX/101	MF01DEX/101	MF01DCX/101	MF01DBX/101	MF01DLX/101	MF01DAX/101

NOTE: For custom requests with dimensions different from the standard, please refer to page 318.

VERSION F 06

SUITABLE FOR CHAINS:

- 981M K 3¼ (See page 38)
- 981M K 83,8 (See page 38)
- PHD 981M K 3¼ (See page 38)
- PHD 981M K 83,8 (See page 38)
- PHDG 981M K 3¼ (See page 46)
- 880M RG K 3¼ (See page 57)
- 880M RG K 83,8 (See page 57)

RADIUS	BASIC WIDTH	TRANSVERSAL PITCH	INFEEED/OUTFEED LENGTH
mm	mm	mm	mm
750	100	85	100



Single track

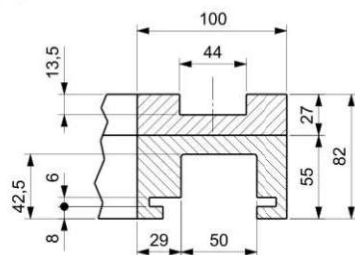

Multi track

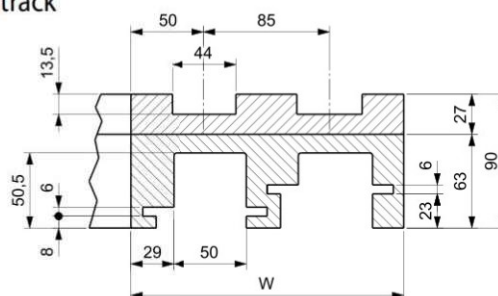

Radius

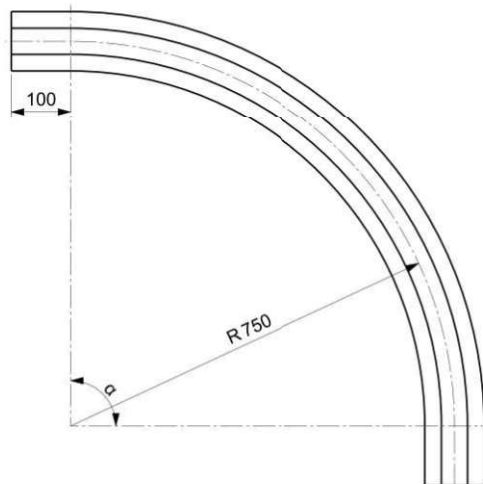

Return guide shoe

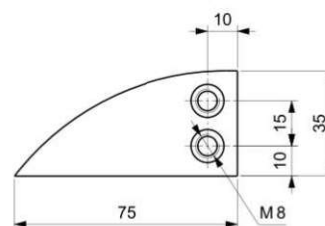

On request, Upper part is available in Self-Lubricating UHMWPE & Oil-filled PA.



PART NUMBER IDENTIFICATION			
CURVES	SUPREME -A	NEW e-SLIDE	SUPREME -S
UPPER PART MATERIAL	UHMWPE	High performance Self-lubricating UHMWPE	Oil-filled PA
PART NUMBERS	See table below	Replace "MF" with "MFE" Example: 2 tracks, 90° curve angle, P/N: MFE02EAY/111	Replace "MF" with "MFP" Example: 2 tracks, 90° curve angle, P/N: MFP02EAY/111

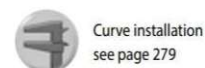

Curve installation see page 279



Curve material see page 278

N. OF TRACKS	TOTAL WIDTH W mm	PART NUMBER					
		Curve angle α					
		15°	30°	45°	60°	75°	90°
1	100	MF01EFX/101	MF01EEX/101	MF01ECX/101	MF01EBX/101	MF01ELX/101	MF01EAX/101
2	185	MF02EFY/111	MF02EEX/111	MF02ECY/111	MF02EBY/111	MF02ELY/111	MF02EAY/111
3	270	MF03EFY/111	MF03EEX/111	MF03ECY/111	MF03EBY/111	MF03ELY/111	MF03EAY/111
4	335	MF04EFY/111	MF04EEX/111	MF04ECY/111	MF04EBY/111	MF04ELY/111	MF04EAY/111
5	400	MF05EFY/111	MF05EEX/111	MF05ECY/111	MF05EBY/111	MF05ELY/111	MF05EAY/111
6	525	MF06EFY/111	MF06EEX/111	MF06ECY/111	MF06EBY/111	MF06ELY/111	MF06EAY/111

NOTE: For custom requests with dimensions different from the standard, please refer to page 318

VERSION F 07

SUITABLE FOR CHAINS:

- 981M K 3¼ (See page 38)
- 981M K 83,8 (See page 38)
- PHD 981M K 3¼ (See page 38)
- PHD 981M K 83,8 (See page 38)
- PHDG 981M K 3¼ (See page 46)
- 880M RG K 3¼ (See page 57)
- 880M RG K 83,8 (See page 57)

RADIUS	BASIC WIDTH	TRANSVERSAL PITCH	INFEED/OUTFEED LENGTH
mm	mm	mm	mm
750	111	85	100



Single track

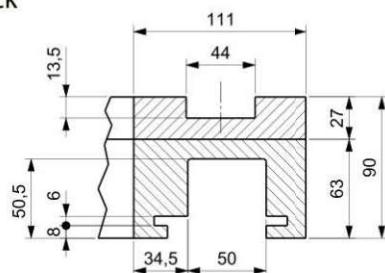

Multi track

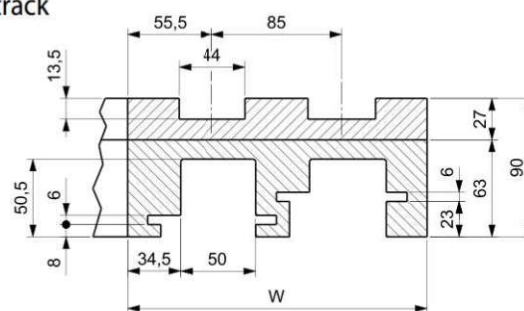

Radius

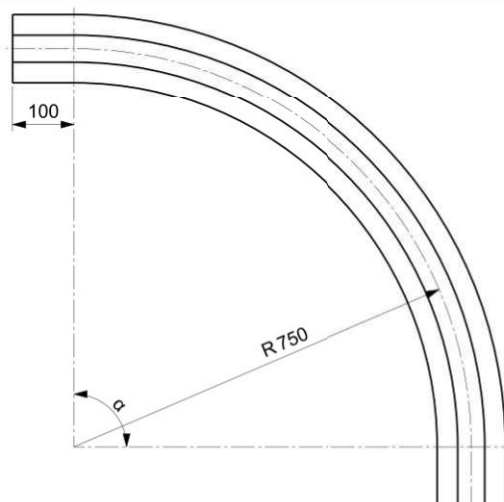

Return guide shoe

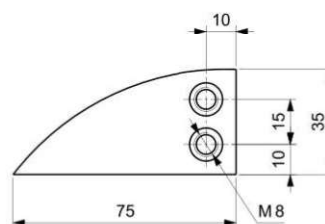

On request, Upper part is available in Self-Lubricating UHMWPE & Oil-filled PA.



PART NUMBER IDENTIFICATION

CURVES	SUPREME -A	NEW e-SLIDE	SUPREME -S
UPPER PART MATERIAL	UHMWPE	High performance Self-lubricating UHMWPE	Oil-filled PA
PART NUMBERS	See table below	Replace "MF" with "MFE" Example: 2 tracks, 90° curve angle, P/N: MFE02EAY/311	Replace "MF" with "MFP" Example: 2 tracks, 90° curve angle, P/N: MFP02EAY/311



Curve installation
see page 279



Curve material
see page 278

N. OF TRACKS	TOTAL WIDTH W mm	PART NUMBER					
		Curve angle α					
		15°	30°	45°	60°	75°	90°
1	111	MF01EFY/301	MF01EEY/301	MF01ECY/301	MF01EBY/301	MF01ELY/301	MF01EAY/301
2	196	MF02EFY/311	MF02EEY/311	MF02ECY/311	MF02EBY/311	MF02ELY/311	MF02EAY/311
3	281	MF03EFY/311	MF03EEY/311	MF03ECY/311	MF03EBY/311	MF03ELY/311	MF03EAY/311
4	366	MF04EFY/311	MF04EEY/311	MF04ECY/311	MF04EBY/311	MF04ELY/311	MF04EAY/311
5	451	MF05EFY/311	MF05EEY/311	MF05ECY/311	MF05EBY/311	MF05ELY/311	MF05EAY/311
6	536	MF06EFY/311	MF06EEY/311	MF06ECY/311	MF06EBY/311	MF06ELY/311	MF06EAY/311

NOTE: For custom requests with dimensions different from the standard, please refer to page 318.

VERSION F 08

SUITABLE FOR CHAINS:

- 981M K 3¼ (See page 38)
- 981M K 83,8 (See page 38)
- PHD 981M K 3¼ (See page 38)
- PHD 981M K 83,8 (See page 38)
- PHDG 981M K 3¼ (See page 46)
- 880M RG K 3¼ (See page 57)
- 880M RG K 83,8 (See page 57)

RADIUS	BASIC WIDTH	TRANSVERSAL PITCH	INFEED/OUTFEED LENGTH
mm	mm	mm	mm
860	100	Single track	125



Single track

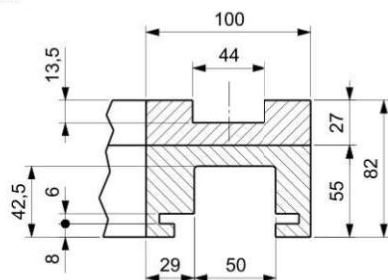

Radius

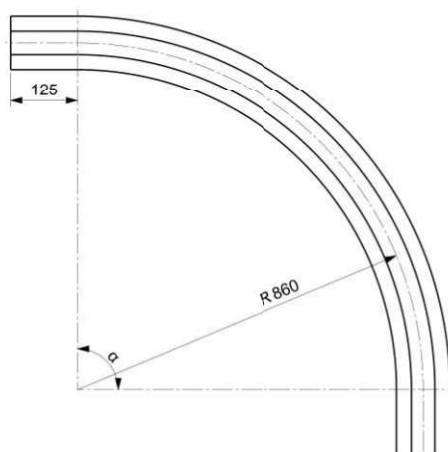

Return guide shoe

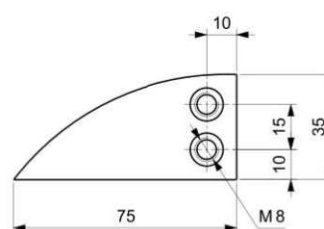

On request, Upper part is available in Self-Lubricating UHMWPE & Oil-filled PA.



PART NUMBER IDENTIFICATION			
CURVES	SUPREME-A	NEW e-SLIDE	SUPREME-S
UPPER PART MATERIAL	UHMWPE	High performance Self-lubricating UHMWPE	Oil-filled PA
PART NUMBERS	See table below	Replace "MF" with "MFE" Example: 1 track, 90° curve angle, P/N: MFE01FAX/102	Replace "MF" with "MFP" Example: 1 track, 90° curve angle, P/N: MFP01FAX/102



Curve installation
see page 279



Curve material
see page 278

N. OF TRACKS	TOTAL WIDTH W mm	PART NUMBER					
		Curve angle α					
		15°	30°	45°	60°	75°	90°
1	100	MF01FFX/102	MF01FEX/102	MF01FCX/102	MF01FBX/102	MF01FLX/102	MF01FAX/102

NOTE: For custom requests with dimensions different from the standard, please refer to page 318.

VERSION F 09

SUITABLE FOR CHAINS:

- 981M K 3¼ (See page 38)
- 981M K 83,8 (See page 38)
- PHD 981M K 3¼ (See page 38)
- PHD 981M K 83,8 (See page 38)
- PHDG 981M K 3¼ (See page 46)
- 880M RG K 3¼ (See page 57)
- 880M RG K 83,8 (See page 57)

RADIUS	BASIC WIDTH	TRANSVERSAL PITCH	INFEED/OUTFEED LENGTH
mm	mm	mm	mm
1000	100	Single track	-



Single track

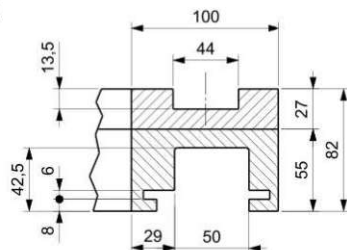

Radius

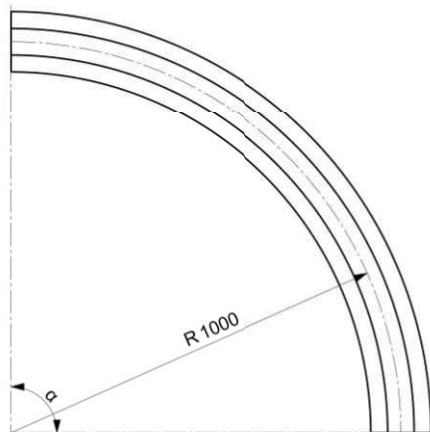

Return guide shoe

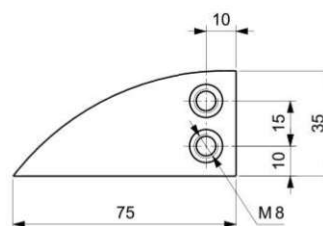

On request, Upper part is available in Self-Lubricating UHMWPE & Oil-filled PA.



PART NUMBER IDENTIFICATION			
CURVES	SUPREME -A	NEW e-SLIDE	SUPREME -S
UPPER PART MATERIAL	UHMWPE	High performance Self-lubricating UHMWPE	Oil-filled PA
PART NUMBERS	See table below	Replace "MF" with "MFE" Example: 1 track, 90° curve angle, P/N: MFE01GAX/102	Replace "MF" with "MFP" Example: 1 track, 90° curve angle, P/N: MFP01GAX/102



Curve installation
see page 279



Curve material
see page 278

N. OF TRACKS	TOTAL WIDTH w mm	PART NUMBER					
		Curve angle α					
		15°	30°	45°	60°	75°	90°
1	100	MF01GFX/100	MF01GEX/100	MF01GCX/100	MF01GBX/100	MF01GLX/100	MF01GAX/100

NOTE: For custom requests with dimensions different from the standard, please refer to page 318.

VERSION F 10

SUITABLE FOR CHAINS:

- 981M K 3¼ (See page 38)
- 981M K 83,8 (See page 38)
- PHD 981M K 3¼ (See page 38)
- PHD 981M K 83,8 (See page 38)
- PHDG 981M K 3¼ (See page 46)
- 880M RG K 3¼ (See page 57)
- 880M RG K 83,8 (See page 57)

RADIUS	BASIC WIDTH	TRANSVERSAL PITCH	INFEED/OUTFEED LENGTH
mm	mm	mm	mm
1000	111	85	100



Single track

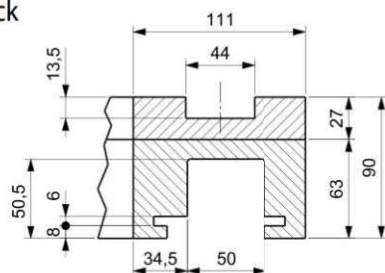

Multi track

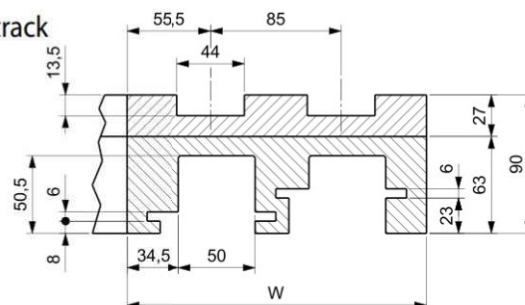

Radius

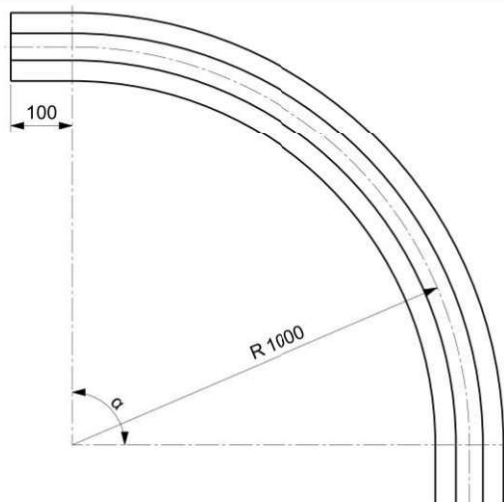

Return guide shoe

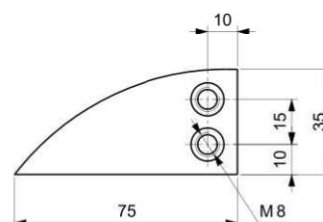

On request, Upper part is available in Self-Lubricating UHMWPE & Oil-filled PA.



PART NUMBER IDENTIFICATION			
CURVES	SUPREME-A	NEW e-SLIDE	SUPREME-S
UPPER PART MATERIAL	UHMWPE	High performance Self-lubricating UHMWPE	Oil-filled PA
PART NUMBERS	See table below	Replace "MF" with "MFE" Example: 2 tracks, 90° curve angle, P/N: MFE02GAY/311	Replace "MF" with "MFP" Example: 2 tracks, 90° curve angle, P/N: MFP02GAY/311



Curve installation see page 279



Curve material see page 278

N. OF TRACKS	TOTAL WIDTH W mm	PART NUMBER					
		Curve angle α					
		15°	30°	45°	60°	75°	90°
1	111	MF01GFY/301	MF01GEY/301	MF01GKY/301	MF01GBY/301	MF01GLY/301	MF01GAY/301
2	196	MF02GFY/311	MF02GEY/311	MF02GKY/311	MF02GBY/311	MF02GLY/311	MF02GAY/311
3	281	MF03GFY/311	MF03GEY/311	MF03GKY/311	MF03GBY/311	MF03GLY/311	MF03GAY/311
4	366	MF04GFY/311	MF04GEY/311	MF04GKY/311	MF04GBY/311	MF04GLY/311	MF04GAY/311
5	451	MF05GFY/311	MF05GEY/311	MF05GKY/311	MF05GBY/311	MF05GLY/311	MF05GAY/311
6	536	MF06GFY/311	MF06GEY/311	MF06GKY/311	MF06GBY/311	MF06GLY/311	MF06GAY/311

NOTE: For custom requests with dimensions different from the standard, please refer to page 318.

VERSION F 11

SUITABLE FOR CHAINS:

- 981M K 4½ (See page 38)
- PHD 981M K 4½ (See page 38)
- 880M RG K 4½ (See page 57)

RADIUS	BASIC WIDTH	TRANSVERSAL PITCH	INFEED/OUTFEED LENGTH
mm	mm	mm	mm
500	129	120	125



Single track

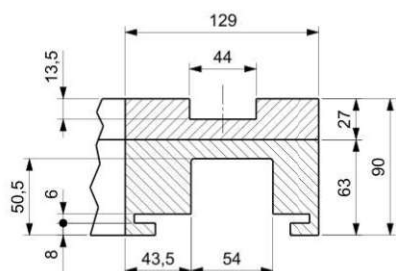

Multi track

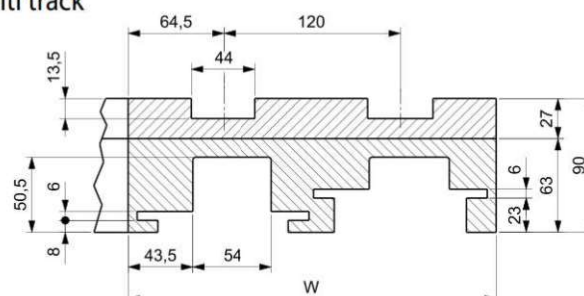

Radius

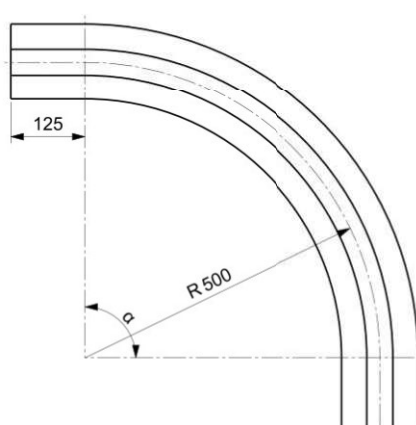

Return guide shoe

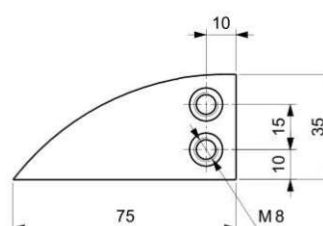

On request, Upper part is available in Self-Lubricating UHMWPE & Oil-filled PA.



PART NUMBER IDENTIFICATION			
CURVES	SUPREME -A	NEW e-SLIDE	SUPREME -S
UPPER PART MATERIAL	UHMWPE	High performance Self-lubricating UHMWPE	Oil-filled PA
PART NUMBERS	See table below	Replace "MF" with "MFE" Example: 2 tracks, 90° curve angle, P/N: MFE02AAY/442	Replace "MF" with "MFP" Example: 2 tracks, 90° curve angle, P/N: MFP02AAY/442



Curve installation
see page 279



Curve material
see page 278

N. OF TRACKS	TOTAL WIDTH W mm	PART NUMBER					
		Curve angle α					
		15°	30°	45°	60°	75°	90°
1	129	MF01AFY/402	MF01AEY/402	MF01ACY/402	MF01ABY/402	MF01ALY/402	MF01AAY/402
2	249	MF02AFY/442	MF02AEY/442	MF02ACY/442	MF02ABY/442	MF02ALY/442	MF02AAY/442
3	369	MF03AFY/442	MF03AEY/442	MF03ACY/442	MF03ABY/442	MF03ALY/442	MF03AAY/442
4	489	MF04AFY/442	MF04AEY/442	MF04ACY/442	MF04ABY/442	MF04ALY/442	MF04AAY/442
5	609	MF05AFY/442	MF05AEY/442	MF05ACY/442	MF05ABY/442	MF05ALY/442	MF05AAY/442
6	729	MF06AFY/442	MF06AEY/442	MF06ACY/442	MF06ABY/442	MF06ALY/442	MF06AAY/442

NOTE: For custom requests with dimensions different from the standard, please refer to page 318.

VERSION F 12

SUITABLE FOR CHAINS:

- 981M K 4½ (See page 38)
- PHD 981M K 4½ (See page 38)
- 880M RG K 4½ (See page 57)

RADIUS	BASIC WIDTH	TRANSVERSAL PITCH	INFEED/OUTFEED LENGTH
mm	mm	mm	mm
610	129	120	125



Single track

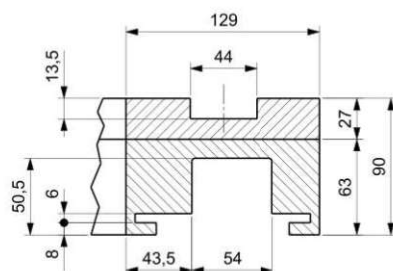

Multi track

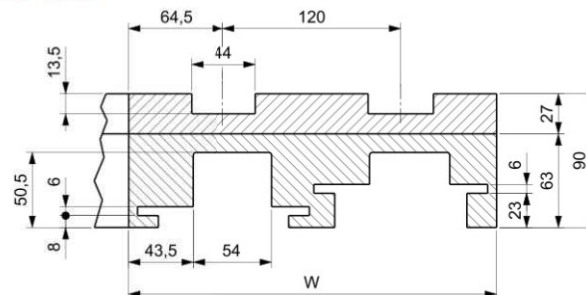

Radius

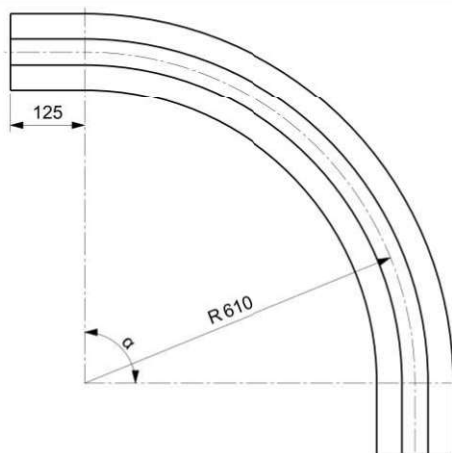

Return guide shoe

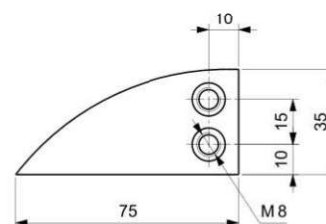

On request, Upper part is available in Self-Lubricating UHMWPE & Oil-filled PA.



PART NUMBER IDENTIFICATION			
CURVES	SUPREME-A	NEW e-SLIDE	SUPREME-S
UPPER PART MATERIAL	UHMWPE	High performance Self-lubricating UHMWPE	Oil-filled PA
PART NUMBERS	See table below	Replace "MF" with "MFE" Example: 2 tracks, 90° curve angle, P/N: MFE02CAY/442	Replace "MF" with "MFP" Example: 2 tracks, 90° curve angle, P/N: MFP02CAY/442

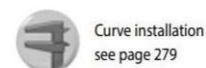

Curve installation see page 279



Curve material see page 278

N. OF TRACKS	TOTAL WIDTH W mm	PART NUMBER					
		Curve angle α					
		15°	30°	45°	60°	75°	90°
1	129	MF01CFY/402	MF01CEY/402	MF01CCY/402	MF01CBY/402	MF01CLY/402	MF01CAY/402
2	249	MF02CFY/442	MF02CEY/442	MF02CCY/442	MF02CBY/442	MF02CLY/442	MF02CAY/442
3	369	MF03CFY/442	MF03CEY/442	MF03CCY/442	MF03CBY/442	MF03CLY/442	MF03CAY/442
4	489	MF04CFY/442	MF04CEY/442	MF04CCY/442	MF04CBY/442	MF04CLY/442	MF04CAY/442
5	609	MF05CFY/442	MF05CEY/442	MF05CCY/442	MF05CBY/442	MF05CLY/442	MF05CAY/442
6	729	MF06CFY/442	MF06CEY/442	MF06CCY/442	MF06CBY/442	MF06CLY/442	MF06CAY/442

NOTE: For custom requests with dimensions different from the standard, please refer to page 318.

VERSION F 13

SUITABLE FOR CHAINS:

- 981M K 4½ (See page 38)
- PHD 981M K 4½ (See page 38)
- 880M RG K 4½ (See page 57)

RADIUS	BASIC WIDTH	TRANSVERSAL PITCH	INFEED/OUTFEED LENGTH
mm	mm	mm	mm
610	129	117	-



Single track

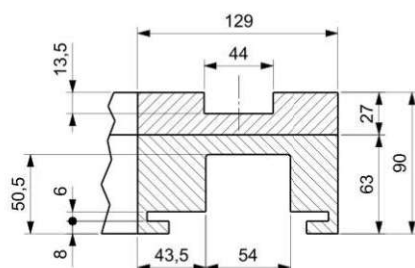

Multi track

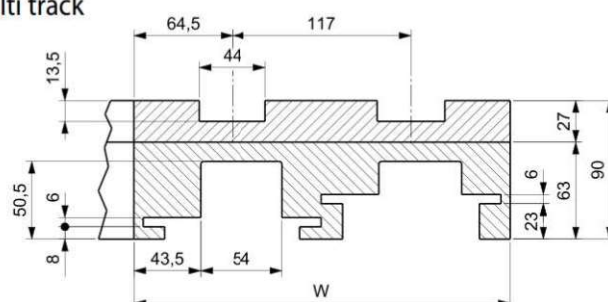

Radius

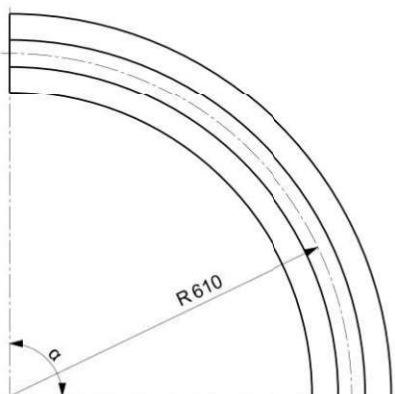

Return guide shoe

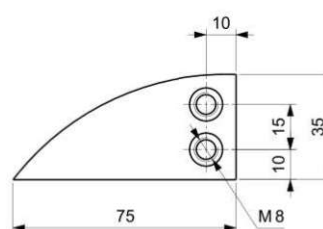

On request, Upper part is available in Self-Lubricating UHMWPE & Oil-filled PA.



PART NUMBER IDENTIFICATION

CURVES	SUPREME-A	NEW e-SLIDE	SUPREME-S
UPPER PART MATERIAL	UHMWPE	High performance Self-lubricating UHMWPE	Oil-filled PA
PART NUMBERS	See table below	Replace "MF" with "MFE" Example: 2 tracks, 90° curve angle, P/N: MFE02CAY/450	Replace "MF" with "MFP" Example: 2 tracks, 90° curve angle, P/N: MFP02CAY/450



Curve installation
see page 279



Curve material
see page 278

N. OF TRACKS	TOTAL WIDTH W mm	PART NUMBER					
		Curve angle α					
		15°	30°	45°	60°	75°	90°
1	129	MF01CFY/400	MF01CEY/400	MF01CCY/400	MF01CBY/400	MF01CLY/400	MF01CAY/400
2	246	MF02CFY/450	MF02CEY/450	MF02CCY/450	MF02CBY/450	MF02CLY/450	MF02CAY/450
3	363	MF03CFY/450	MF03CEY/450	MF03CCY/450	MF03CBY/450	MF03CLY/450	MF03CAY/450
4	480	MF04CFY/450	MF04CEY/450	MF04CCY/450	MF04CBY/450	MF04CLY/450	MF04CAY/450
5	597	MF05CFY/450	MF05CEY/450	MF05CCY/450	MF05CBY/450	MF05CLY/450	MF05CAY/450
6	714	MF06CFY/450	MF06CEY/450	MF06CCY/450	MF06CBY/450	MF06CLY/450	MF06CAY/450

NOTE: For custom requests with dimensions different from the standard, please refer to page 318.

VERSION F 14

SUITABLE FOR CHAINS:

- 981M K 7½ (See page 38)
- PHD 981M K 7½ (See page 38)
- PHDG 981M K 7½ (See page 46)

RADIUS	BASIC WIDTH	TRANSVERSAL PITCH	INFEED/OUTFEED LENGTH
mm	mm	mm	mm
610	214	196	125



Single track

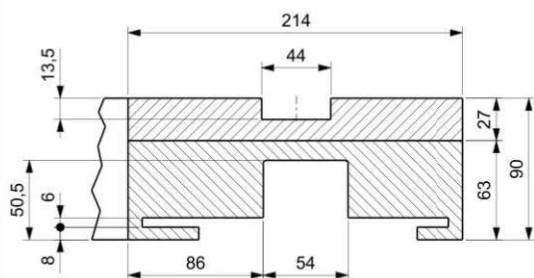

Multi track

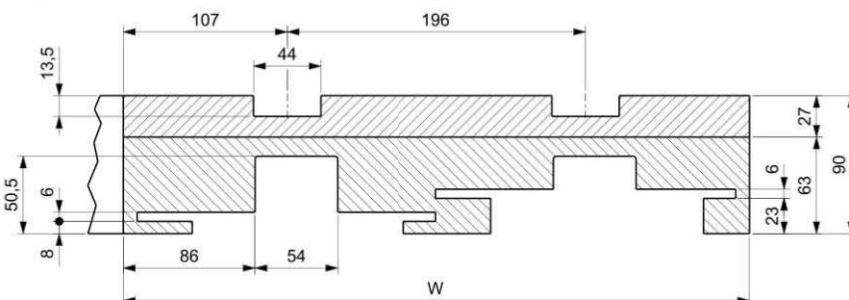

Radius

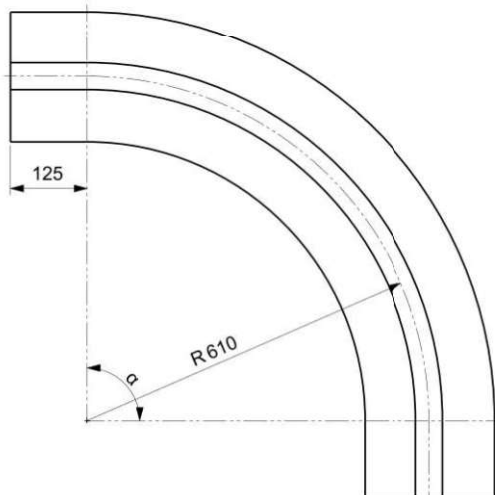

Return guide shoe

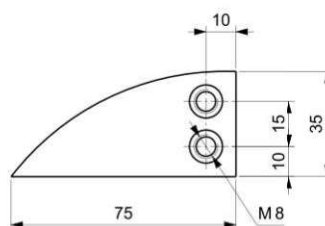

On request, Upper part is available in Self-Lubricating UHMWPE & Oil-filled PA.



PART NUMBER IDENTIFICATION			
CURVES	SUPREME -A	NEW e-SLIDE	SUPREME -S
UPPER PART MATERIAL	UHMWPE	High performance Self-lubricating UHMWPE	Oil-filled PA
PART NUMBERS	See table below	Replace "MF" with "MFE" Example: 2 tracks, 90° curve angle, P/N: MFE02CAY/672	Replace "MF" with "MFP" Example: 2 tracks, 90° curve angle, P/N: MFP02CAY/672



Curve installation see page 279



Curve material see page 278

N. OF TRACKS	TOTAL WIDTH W mm	PART NUMBER					
		Curve angle α					
		15°	30°	45°	60°	75°	90°
1	214	MF01CFY/602	MF01CEY/602	MF01CCY/602	MF01CBY/602	MF01CLY/602	MF01CAY/602
2	410	MF02CFY/672	MF02CEY/672	MF02CCY/672	MF02CBY/672	MF02CLY/672	MF02CAY/672
3	606	MF03CFY/672	MF03CEY/672	MF03CCY/672	MF03CBY/672	MF03CLY/672	MF03CAY/672
4	802	MF04CFY/672	MF04CEY/672	MF04CCY/672	MF04CBY/672	MF04CLY/672	MF04CAY/672

NOTE: For custom requests with dimensions different from the standard, please refer to page 318.

VERSION F 15

SUITABLE FOR CHAINS:

- 981M K 7½ (See page 38)
- PHD 981M K 7½ (See page 38)
- PHDG 981M K 7½ (See page 46)

RADIUS	BASIC WIDTH	TRANSVERSAL PITCH	INFEED/OUTFEED LENGTH
mm	mm	mm	mm
860	214	Single track	-

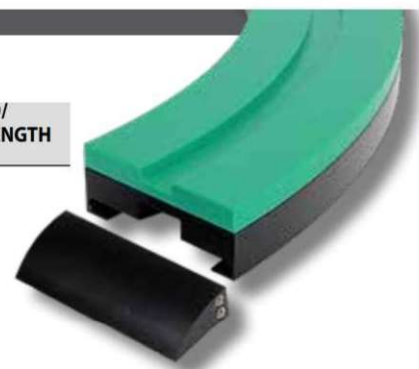

Single track

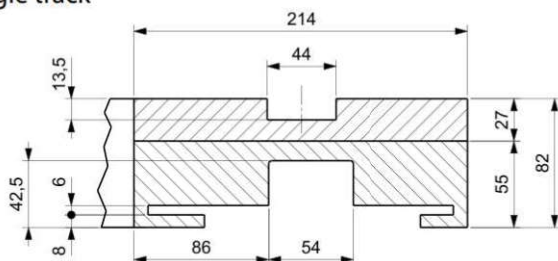

Radius

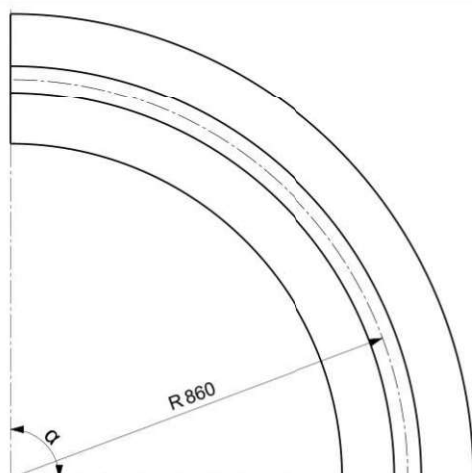

Return guide shoe

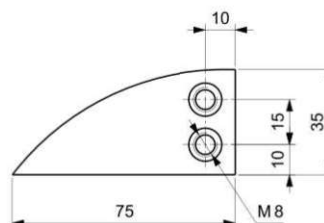

On request, Upper part is available in Self-Lubricating UHMWPE & Oil-filled PA.



PART NUMBER IDENTIFICATION			
CURVES	SUPREME -A	NEW e-SLIDE	SUPREME -S
UPPER PART MATERIAL	UHMWPE	High performance Self-lubricating UHMWPE	Oil-filled PA
PART NUMBERS	See table below	Replace "MF" with "MFE" Example: 1 track, 90° curve angle, P/N: MFE01FAX/600	Replace "MF" with "MFP" Example: 1 track, 90° curve angle, P/N: MFP01FAX/600



Curve installation
see page 279



Curve material
see page 278

N. OF TRACKS	TOTAL WIDTH W mm	PART NUMBER					
		Curve angle α					
		15°	30°	45°	60°	75°	90°
1	214	MF01FFX/600	MF01FEX/600	MF01FCX/600	MF01FBX/600	MF01FLX/600	MF01FAX/600

NOTE: For custom requests with dimensions different from the standard, please refer to page 318.

VERSION F 16

SUITABLE FOR CHAINS:

- 981M K 7½ (See page 38)
- PHD 981M K 7½ (See page 38)
- PHDG 981M K 7½ (See page 46)

RADIUS	BASIC WIDTH	TRANSVERSAL PITCH	INFEED/OUTFEED LENGTH
mm	mm	mm	mm
1000	214	Single track	-

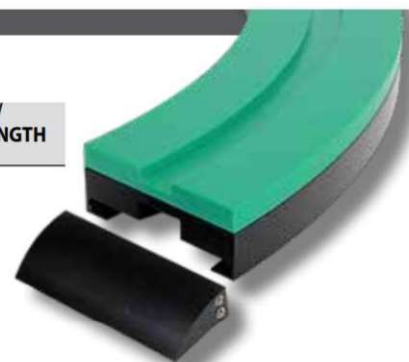

Single track

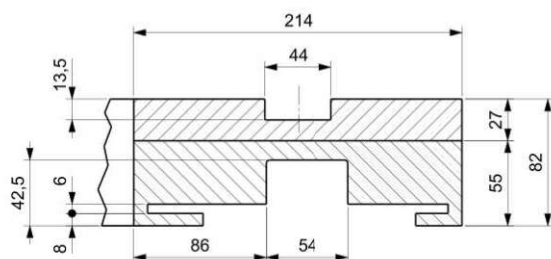

Radius

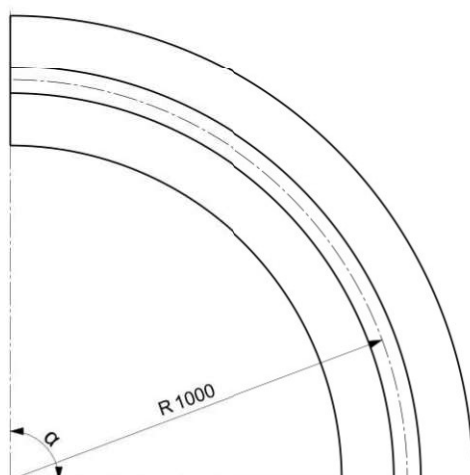

Return guide shoe

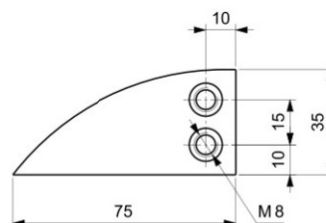

On request, Upper part is available in Self-Lubricating UHMWPE & Oil-filled PA.



PART NUMBER IDENTIFICATION			
CURVES	SUPREME -A	NEW e-SLIDE	SUPREME -S
UPPER PART MATERIAL	UHMWPE	High performance Self-lubricating UHMWPE	Oil-filled PA
PART NUMBERS	See table below	Replace "MF" with "MFE" Example: 1 track, 90° curve angle, P/N: MFE01GAX/600	Replace "MF" with "MFP" Example: 1 track, 90° curve angle, P/N: MFP01GAX/600

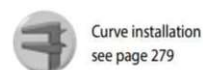

Curve installation see page 279



Curve material see page 278

N. OF TRACKS	TOTAL WIDTH W mm	PART NUMBER					
		Curve angle α					
		15°	30°	45°	60°	75°	90°
1	214	MF01GFX/600	MF01GEX/600	MF01GCX/600	MF01GBX/600	MF01GLX/600	MF01GAX/600

NOTE: For custom requests with dimensions different from the standard, please refer to page 318.

VERSION H 01

SUITABLE FOR CHAINS:

- PHD 9857M K 7½ (See page 39)
- PHDG 9857M K 7½ (See page 47)
- 882M K 7½ (See page 62)
- HFX 882M K 7½ (See page 71)

RADIUS	BASIC WIDTH	TRANSVERSAL PITCH	INFEED/OUTFEED LENGTH
mm	mm	mm	mm
610	200	195	100



Single track

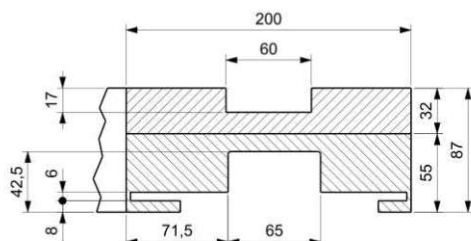

Multi track

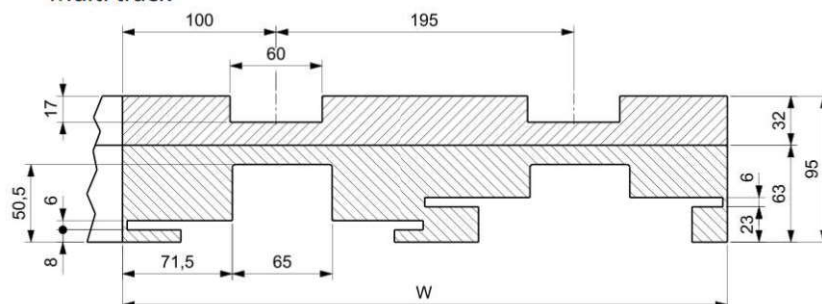

Radius

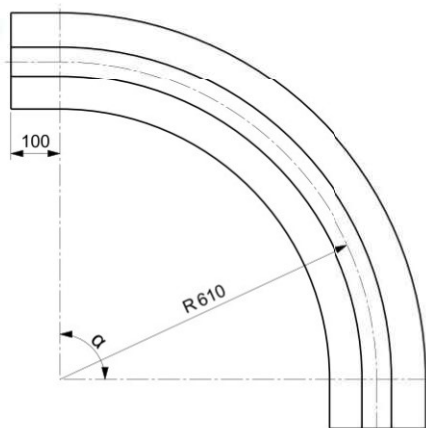

Return guide shoe

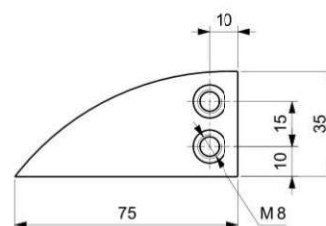

On request, Upper part is available in Self-Lubricating UHMWPE & Oil-filled PA.



PART NUMBER IDENTIFICATION			
CURVES	SUPREME -A	NEW SLIDE	SUPREME -S
UPPER PART MATERIAL	UHMWPE	High performance Self-lubricating UHMWPE	Oil-filled PA
PART NUMBERS	See table below	Replace "MH" with "MHE" Example: 2 tracks, 90° curve angle, P/N: MHE02CAZ/561	Replace "MH" with "MHP" Example: 2 tracks, 90° curve angle, P/N: MHP02CAZ/561



Curve installation
see page 279



Curve material
see page 278

N. OF TRACKS	TOTAL WIDTH W mm	PART NUMBER					
		Curve angle alpha					
		15°	30°	45°	60°	75°	90°
1	200	MH01CFW/501	MH01CEW/501	MH01CCW/501	MH01CBW/501	MH01CLW/501	MH01CAW/501
2	395	MH02CFZ/561	MH02CEZ/561	MH02CCZ/561	MH02CBZ/561	MH02CLZ/561	MH02CAZ/561
3	590	MH03CFZ/561	MH03CEZ/561	MH03CCZ/561	MH03CBZ/561	MH03CLZ/561	MH03CAZ/561
4	785	MH04CFZ/561	MH04CEZ/561	MH04CCZ/561	MH04CBZ/561	MH04CLZ/561	MH04CAZ/561

NOTE: For custom requests with dimensions different from the standard, please refer to page 318.

VERSION H 02

SUITABLE FOR CHAINS:

- PHD 9857M K 7½ (See page 39)
- PHDG 9857M K 7½ (See page 47)
- 882M K 7½ (See page 62)
- HFX 882M K 7½ (See page 71)

RADIUS	BASIC WIDTH	TRANSVERSAL PITCH	INFEEED/OUTFEED LENGTH
mm	mm	mm	mm
750	200	195	100



Single track

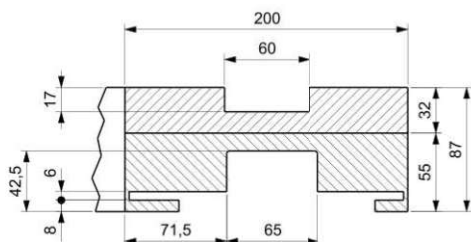

Multi track

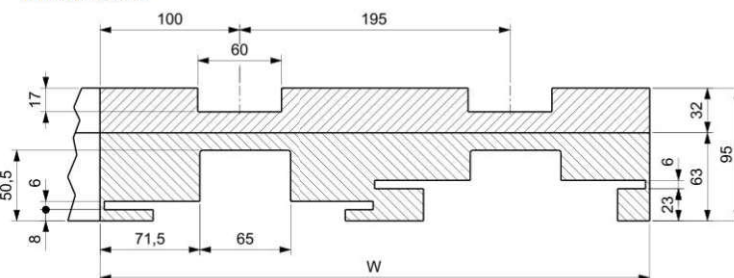

Radius

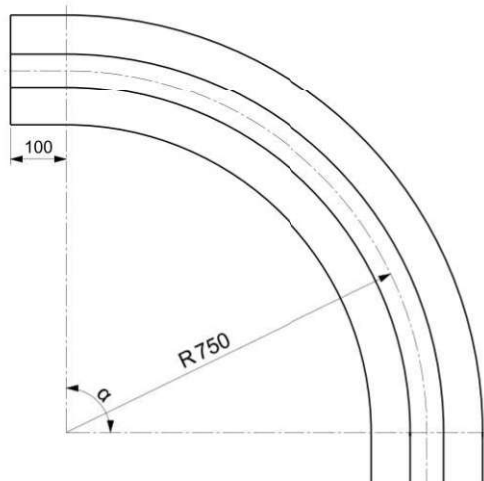

Return guide shoe

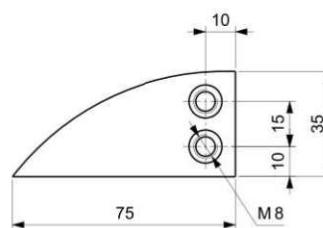

On request, Upper part is available in Self-Lubricating UHMWPE & Oil-filled PA.



PART NUMBER IDENTIFICATION			
CURVES	SUPREME -A	NEW e-SLIDE	SUPREME -S
UPPER PART MATERIAL	UHMWPE	High performance Self-lubricating UHMWPE	Oil-filled PA
PART NUMBERS	See table below	Replace "MH" with "MHE" Example: 2 tracks, 90° curve angle, P/N: MHE02EAZ/561	Replace "MH" with "MHP" Example: 2 tracks, 90° curve angle, P/N: MHP02EAZ/561



Curve installation see page 279



Curve material see page 278

N. OF TRACKS	TOTAL WIDTH W mm	PART NUMBER					
		Curve angle α					
		15°	30°	45°	60°	75°	90°
1	200	MH01EFW/501	MH01EEW/501	MH01ECW/501	MH01EBW/501	MH01ELW/501	MH01EAW/501
2	395	MH02EFZ/561	MH02EEZ/561	MH02ECZ/561	MH02EBZ/561	MH02ELZ/561	MH02EAZ/561
3	590	MH03EFZ/561	MH03EEZ/561	MH03ECZ/561	MH03EBZ/561	MH03ELZ/561	MH03EAZ/561
4	785	MH04EFZ/561	MH04EEZ/561	MH04ECZ/561	MH04EBZ/561	MH04ELZ/561	MH04EAZ/561

NOTE: For custom requests with dimensions different from the standard, please refer to page 318.

VERSION H 03

SUITABLE FOR CHAINS:

- PHD 9857M K 7½ (See page 39)
- PHDG 9857M K 7½ (See page 47)
- 882M K 7½ (See page 62)
- HFX 882M K 7½ (See page 71)

RADIUS	BASIC WIDTH	TRANSVERSAL PITCH	INFEED/OUTFEED LENGTH
mm	mm	mm	mm
860	214	Single track	-

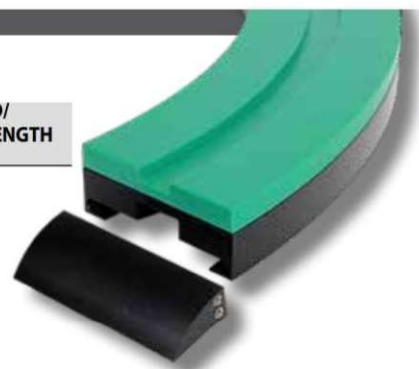

Single track

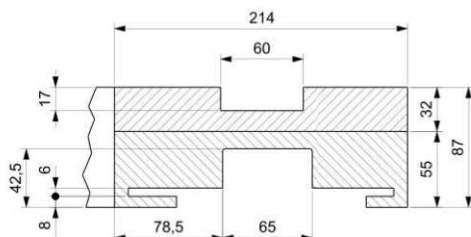

Radius

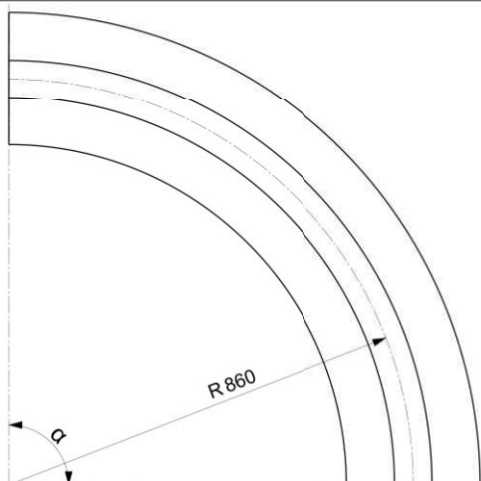

Return guide shoe

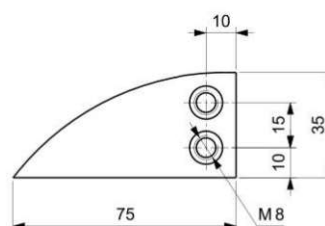

On request, Upper part is available in Self-Lubricating UHMWPE & Oil-filled PA.



PART NUMBER IDENTIFICATION			
CURVES	SUPREME -A	NEW SLIDE	SUPREME -S
UPPER PART MATERIAL	UHMWPE	High performance Self-lubricating UHMWPE	Oil-filled PA
PART NUMBERS	See table below	Replace "MH" with "MHE" Example: 1 track, 90° curve angle, P/N: MHE01FAW/600	Replace "MH" with "MHP" Example: 1 track, 90° curve angle, P/N: MHP01FAW/600



Curve installation
see page 279



Curve material
see page 278

N. OF TRACKS	TOTAL WIDTH W mm	PART NUMBER					
		Curve angle α					
		15°	30°	45°	60°	75°	90°
1	214	MH01FFW/600	MH01FEW/600	MH01FCW/600	MH01FBW/600	MH01FLW/600	MH01FAW/600

NOTE: For custom requests with dimensions different from the standard, please refer to page 318.

VERSION H 04

SUITABLE FOR CHAINS:

- PHD 9857M K 7½ (See page 39)
- PHDG 9857M K 7½ (See page 47)
- 882M K 7½ (See page 62)
- HFX 882M K 7½ (See page 71)

RADIUS	BASIC WIDTH	TRANSVERSAL PITCH	INFEED/ OUFEEED LENGTH
mm	mm	mm	mm
1000	214	Single track	-

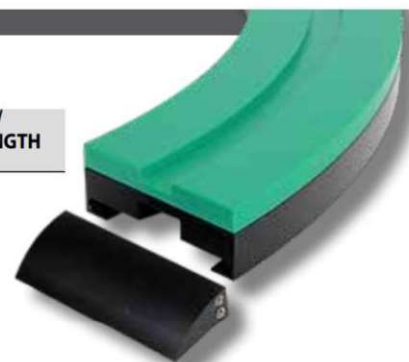

Single track

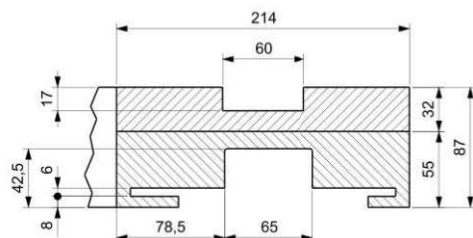

Radius

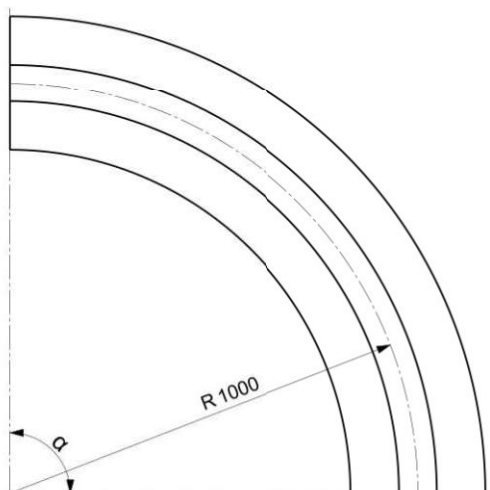

Return guide shoe

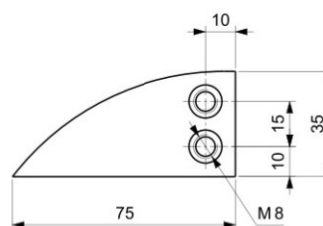

On request, Upper part is available in Self-Lubricating UHMWPE & Oil-filled PA.



PART NUMBER IDENTIFICATION			
CURVES	SUPREME -A	NEW e-SLIDE	SUPREME -S
UPPER PART MATERIAL	UHMWPE	High performance Self-lubricating UHMWPE	Oil-filled PA
PART NUMBERS	See table below	Replace "MH" with "MHE" Example: 1 track, 90° curve angle, P/N: MHE01GAW/600	Replace "MH" with "MHP" Example: 1 track, 90° curve angle, P/N: MHP01GAW/600



Curve installation
see page 279



Curve material
see page 278

N. OF TRACKS	TOTAL WIDTH W mm	PART NUMBER					
		Curve angle α					
		15°	30°	45°	60°	75°	90°
1	214	MH01GFW/600	MH01GEW/600	MH01GCW/600	MH01GBW/600	MH01GLW/600	MH01GAW/600

NOTE: For custom requests with dimensions different from the standard, please refer to page 318.

VERSION H 05

SUITABLE FOR CHAINS:

- 882M K 10 (See page 62)
- HFX 882M K 10 (See page 71)

RADIUS	BASIC WIDTH	TRANSVERSAL PITCH	INFEED/OUTFEED LENGTH
mm	mm	mm	mm
860	290	Single track	-

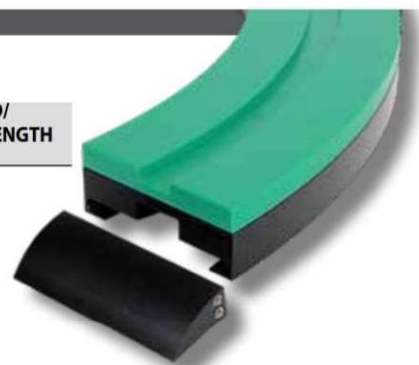

Single track

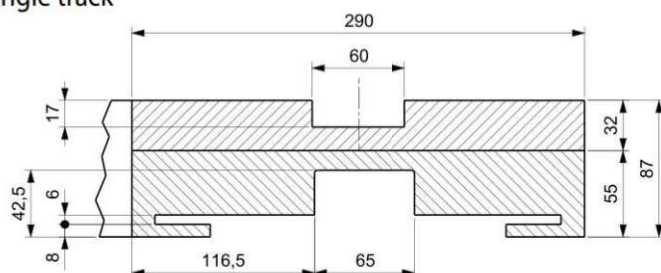

Radius

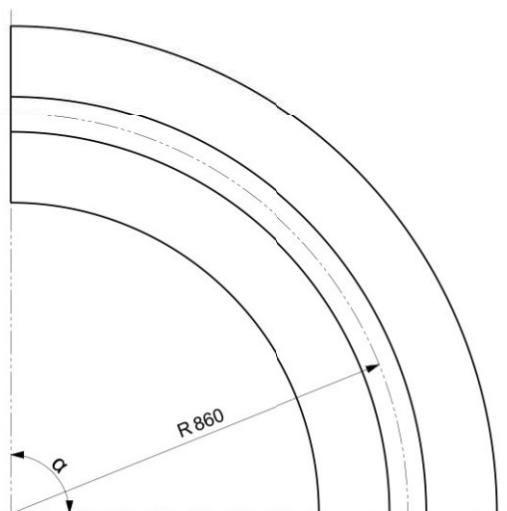

Return guide shoe

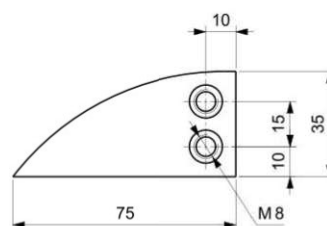

On request, Upper part is available in Self-Lubricating UHMWPE & Oil-filled PA.



PART NUMBER IDENTIFICATION			
CURVES	SUPREME -A	NEW e-SLIDE	SUPREME -S
UPPER PART MATERIAL	UHMWPE	High performance Self-lubricating UHMWPE	Oil-filled PA
PART NUMBERS	See table below	Replace "MH" with "MHE" Example: 1 track, 90° curve angle, P/N: MHE01FAW/L00	Replace "MH" with "MHP" Example: 1 track, 90° curve angle, P/N: MHP01FAW/L00



Curve installation
see page 279



Curve material
see page 278

N. OF TRACKS	TOTAL WIDTH w mm	PART NUMBER					
		Curve angle α					
		15°	30°	45°	60°	75°	90°
1	290	MH01FFW/L00	MH01FEW/L00	MH01FCW/L00	MH01FBW/L00	MH01FLW/L00	MH01FAW/L00

NOTE: For custom requests with dimensions different from the standard, please refer to page 318.

VERSION H 06

SUITABLE FOR CHAINS:

- 882M K 12 (See page 62)
- HFX 882M K 12 (See page 71)

RADIUS	BASIC WIDTH	TRANSVERSAL PITCH	INFEED/OUTFEED LENGTH
mm	mm	mm	mm
860	340	Single track	-

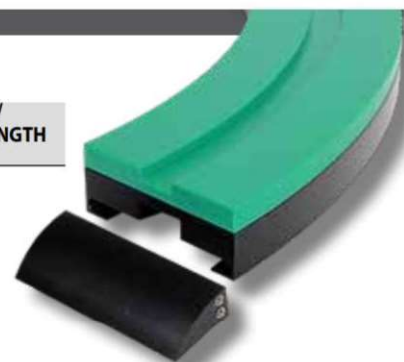

Single track

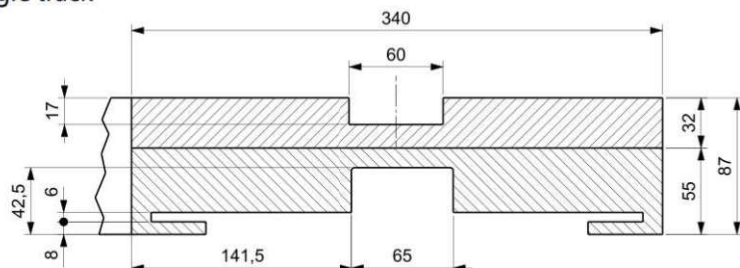

Radius

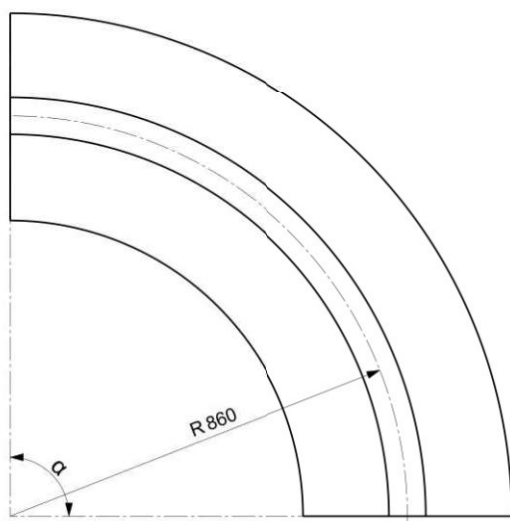

Return guide shoe

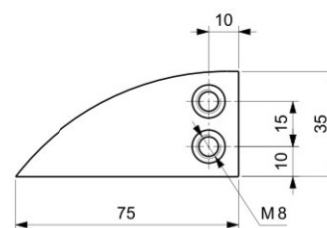

On request, Upper part is available in Self-Lubricating UHMWPE & Oil-filled PA.



PART NUMBER IDENTIFICATION			
CURVES	SUPREME-A	NEW e-SLIDE	SUPREME-S
UPPER PART MATERIAL	UHMWPE	High performance Self-lubricating UHMWPE	Oil-filled PA
PART NUMBERS	See table below	Replace "MH" with "MHE" Example: 1 track, 90° curve angle, P/N: MHE01FAW/J00	Replace "MH" with "MHP" Example: 1 track, 90° curve angle, P/N: MHP01FAW/J00



Curve installation see page 279



Curve material see page 278

N. OF TRACKS	TOTAL WIDTH W mm	PART NUMBER					
		Curve angle α					
		15°	30°	45°	60°	75°	90°
1	340	MH01FFW/J00	MH01FEW/J00	MH01FCW/J00	MH01FBW/J00	MH01FLW/J00	MH01FAW/J00

NOTE: For custom requests with dimensions different from the standard, please refer to page 318.

VERSION L 01

SUITABLE FOR CHAINS:

- LBP 882M K 7½

(See page 109)

RADIUS	BASIC WIDTH	TRANSVERSAL PITCH	INFEED/OUTFEED LENGTH
mm	mm	mm	mm
860	214	Single track	-



Single track

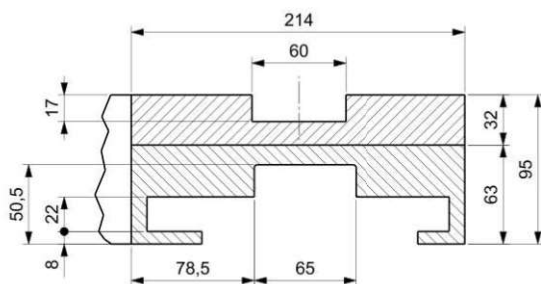

Radius

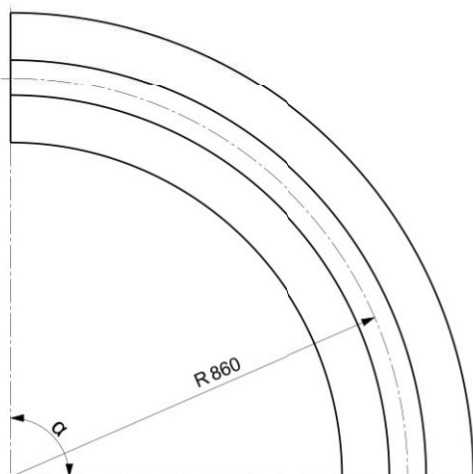

Return guide shoe

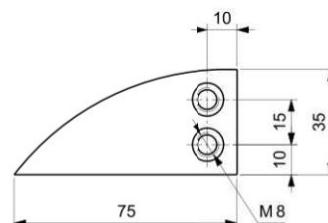

On request, Upper part is available in Self-Lubricating UHMWPE & Oil-filled PA.



PART NUMBER IDENTIFICATION			
CURVES	SUPREME -A	NEW e-SLIDE	SUPREME -S
UPPER PART MATERIAL	UHMWPE	High performance Self-lubricating UHMWPE	Oil-filled PA
PART NUMBERS	See table below	Replace "ML" with "MLE" Example: 1 track, 90° curve angle, P/N: MLE01FAZ/600	Replace "ML" with "MLP" Example: 1 track, 90° curve angle, P/N: MLP01FAZ/600



Curve installation
see page 279



Curve material
see page 278

N. OF TRACKS	TOTAL WIDTH W mm	PART NUMBER					
		Curve angle α					
		15°	30°	45°	60°	75°	90°
1	214	ML01FFZ/600	ML01FEZ/600	ML01FCZ/600	ML01FBZ/600	ML01FLZ/600	ML01FAZ/600

NOTE: For custom requests with dimensions different from the standard, please refer to page 318.

VERSION L 02

SUITABLE FOR CHAINS:

- LBP 882M K 10

(See page 109)

RADIUS	BASIC WIDTH	TRANSVERSAL PITCH	INFEED/OUTFEED LENGTH
mm	mm	mm	mm
860	290	Single track	-

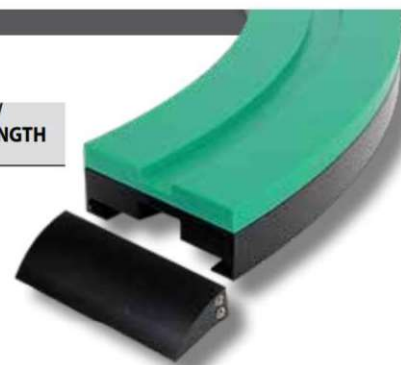

Single track

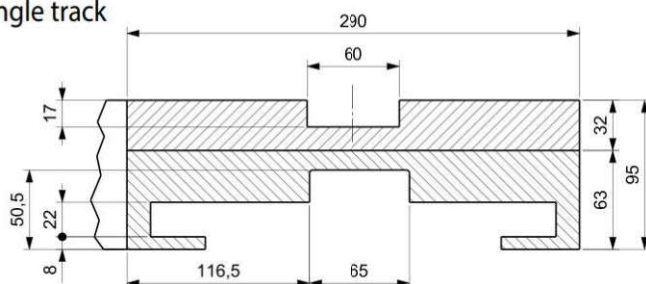

Radius

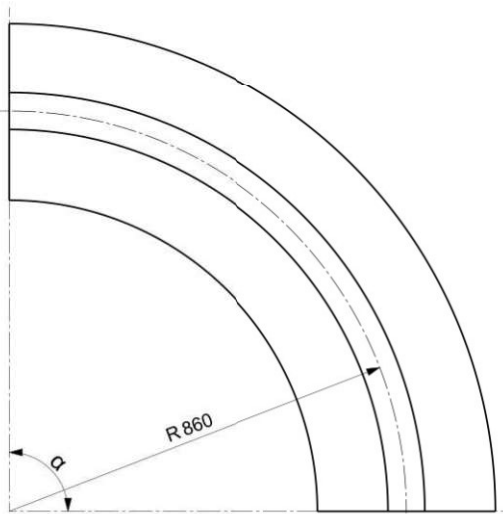

Return guide shoe

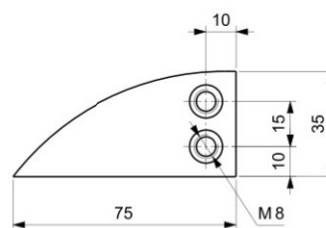

On request, Upper part is available in Self-Lubricating UHMWPE & Oil-filled PA.



PART NUMBER IDENTIFICATION			
CURVES	SUPREME -A	NEW e-SLIDE	SUPREME -S
UPPER PART MATERIAL	UHMWPE	High performance Self-lubricating UHMWPE	Oil-filled PA
PART NUMBERS	See table below	Replace "ML" with "MLE" Example: 1 track, 90° curve angle, P/N: MLE01FAZ/L00	Replace "ML" with "MLP" Example: 1 track, 90° curve angle, P/N: MLP01FAZ/L00



Curve installation
see page 279



Curve material
see page 278

N. OF TRACKS	TOTAL WIDTH W mm	PART NUMBER					
		Curve angle α					
		15°	30°	45°	60°	75°	90°
1	290	ML01FFZ/L00	ML01FEZ/L00	ML01FCZ/L00	ML01FBZ/L00	ML01FLZ/L00	ML01FAZ/L00

NOTE: For custom requests with dimensions different from the standard, please refer to page 318.

VERSION L 03

SUITABLE FOR CHAINS:

- LBP 882M K 12

(See page 109)

RADIUS	BASIC WIDTH	TRANSVERSAL PITCH	INFEED/OUTFEED LENGTH
mm	mm	mm	mm
860	340	Single track	-

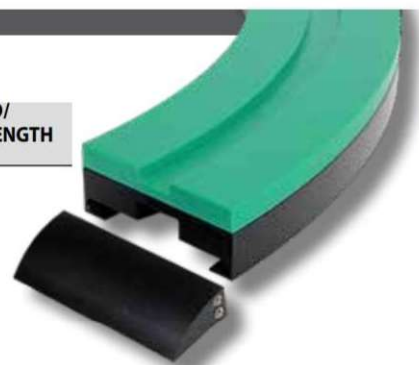

Single track

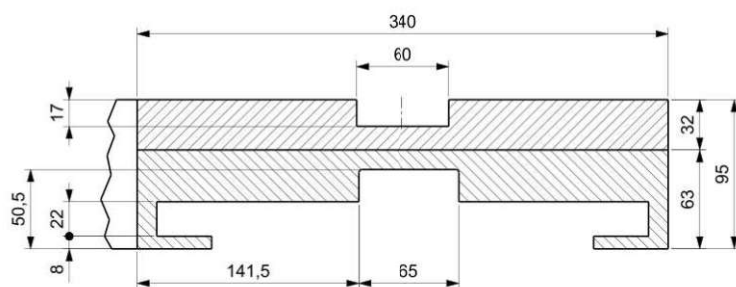

Radius

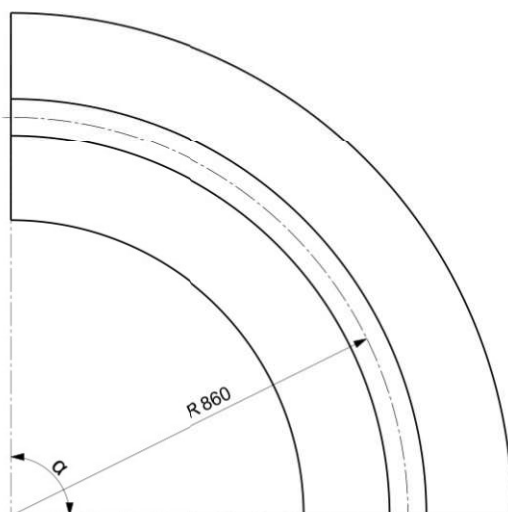

Return guide shoe

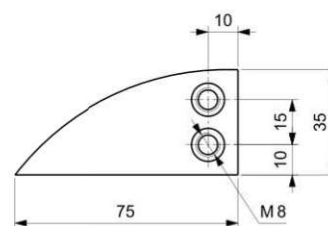

On request, Upper part is available in Self-Lubricating UHMWPE & Oil-filled PA.



PART NUMBER IDENTIFICATION			
CURVES	SUPREME -A	NEW e-SLIDE	SUPREME -S
UPPER PART MATERIAL	UHMWPE	High performance Self-lubricating UHMWPE	Oil-filled PA
PART NUMBERS	See table below	Replace "ML" with "MLE" Example: 1 track, 90° curve angle, P/N: MLE01FAZ/J00	Replace "ML" with "MLP" Example: 1 track, 90° curve angle, P/N: MLP01FAZ/J00



Curve installation
see page 279



Curve material
see page 278

N. OF TRACKS	TOTAL WIDTH w mm	PART NUMBER					
		Curve angle α					
		15°	30°	45°	60°	75°	90°
1	340	ML01FFZ/J00	ML01FEZ/J00	ML01FCZ/J00	ML01FBZ/J00	ML01FLZ/J00	ML01FAZ/J00

NOTE: For custom requests with dimensions different from the standard, please refer to page 318.

VERSION M 01

SUITABLE FOR CHAINS:

- 782M K 83,8 (See page 247)
- 783M K 83,8 (See page 247)

RADIUS	BASIC WIDTH	TRANSVERSAL PITCH	INFEEED/OUTFEED LENGTH
mm	mm	mm	mm
500	100	85	-



Single track

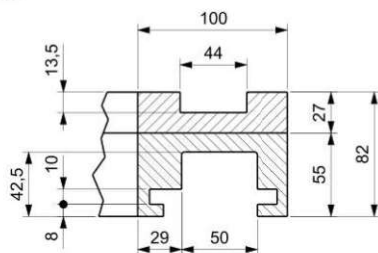

Multi track

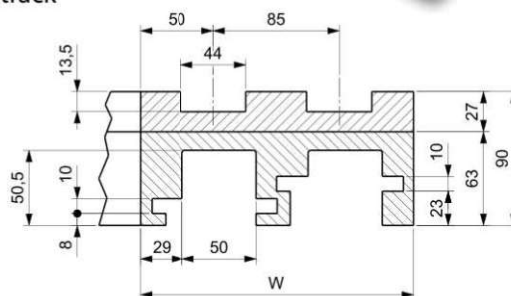

Radius

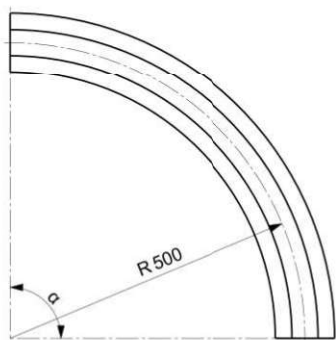

Return guide shoe

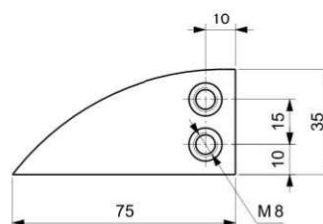

On request, Upper part is available in Self-Lubricating UHMWPE & Oil-filled PA.



PART NUMBER IDENTIFICATION			
CURVES	SUPREME -A	NEW e-SLIDE	SUPREME -S
UPPER PART MATERIAL	UHMWPE	High performance Self-lubricating UHMWPE	Oil-filled PA
PART NUMBERS	See table below	Replace "MM" with "MME" Example: 2 tracks, 90° curve angle, P/N: MME02AAY/110	Replace "MM" with "MMP" Example: 2 tracks, 90° curve angle, P/N: MMP02AAY/110



Curve installation
see page 279



Curve material
see page 278

N. OF TRACKS	TOTAL WIDTH W mm	PART NUMBER					
		Curve angle alpha					
		15°	30°	45°	60°	75°	90°
1	100	MM01AFX/100	MM01AEX/100	MM01ACX/100	MM01ABX/100	MM01ALX/100	MM01AAX/100
2	185	MM02AFY/110	MM02AEY/110	MM02ACY/110	MM02ABY/110	MM02ALY/110	MM02AAY/110
3	270	MM03AFY/110	MM03AEY/110	MM03ACY/110	MM03ABY/110	MM03ALY/110	MM03AAY/110
4	355	MM04AFY/110	MM04AEY/110	MM04ACY/110	MM04ABY/110	MM04ALY/110	MM04AAY/110
5	440	MM05AFY/110	MM05AEY/110	MM05ACY/110	MM05ABY/110	MM05ALY/110	MM05AAY/110
6	525	MM06AFY/110	MM06AEY/110	MM06ACY/110	MM06ABY/110	MM06ALY/110	MM06AAY/110

NOTE: For custom requests with dimensions different from the standard, please refer to page 318.

VERSION M 02

SUITABLE FOR CHAINS:

- 782M K 83,8 (See page 247)
- 783M K 83,8 (See page 247)

RADIUS	BASIC WIDTH	TRANSVERSAL PITCH	INFEED/OUTFEED LENGTH
mm	mm	mm	mm
500	100	85	100



Single track

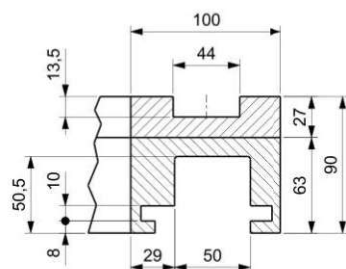

Multi track

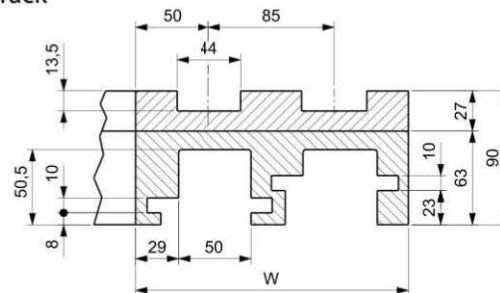

Radius

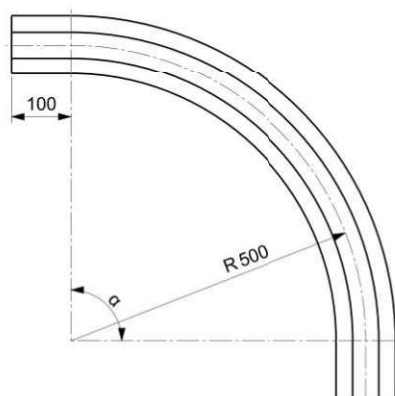

Return guide shoe

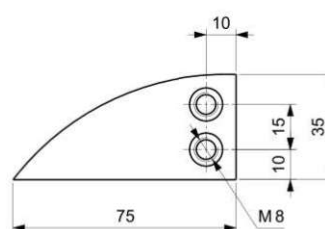

On request, Upper part is available in Self-Lubricating UHMWPE & Oil-filled PA.



PART NUMBER IDENTIFICATION			
CURVES	SUPREME -A	NEW e-SLIDE	SUPREME -S
UPPER PART MATERIAL	UHMWPE	High performance Self-lubricating UHMWPE	Oil-filled PA
PART NUMBERS	See table below	Replace "MM" with "MME" Example: 2 tracks, 90° curve angle, P/N: NME02AAY/111	Replace "MM" with "MMP" Example: 2 tracks, 90° curve angle, P/N: MMP02AAY/111



Curve installation
see page 279



Curve material
see page 278

N. OF TRACKS	TOTAL WIDTH W mm	PART NUMBER					
		Curve angle α					
		15°	30°	45°	60°	75°	90°
1	100	MM01AFY/101	MM01AEY/101	MM01ACY/101	MM01ABY/101	MM01ALY/101	MM01AAY/101
2	185	MM02AFY/111	MM02AEY/111	MM02ACY/111	MM02ABY/111	MM02ALY/111	MM02AAY/111
3	270	MM03AFY/111	MM03AEY/111	MM03ACY/111	MM03ABY/111	MM03ALY/111	MM03AAY/111
4	355	MM04AFY/111	MM04AEY/111	MM04ACY/111	MM04ABY/111	MM04ALY/111	MM04AAY/111
5	440	MM05AFY/111	MM05AEY/111	MM05ACY/111	MM05ABY/111	MM05ALY/111	MM05AAY/111
6	525	MM06AFY/111	MM06AEY/111	MM06ACY/111	MM06ABY/111	MM06ALY/111	MM06AAY/111

NOTE: For custom requests with dimensions different from the standard, please refer to page 318.

VERSION M 03

SUITABLE FOR CHAINS:

- 782M K 83,8 (See page 247)
- 783M K 83,8 (See page 247)

RADIUS	BASIC WIDTH	TRANSVERSAL PITCH	INFEED/OUTFEED LENGTH
mm	mm	mm	mm
500	111	85	100



Single track

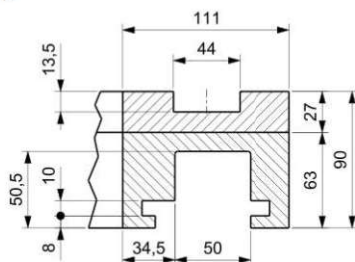

Multi track

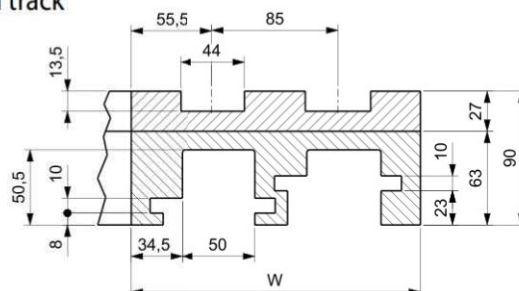

Radius

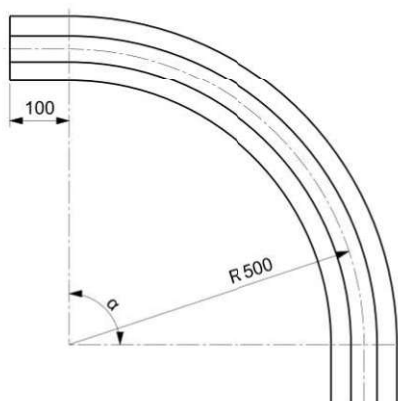

Return guide shoe

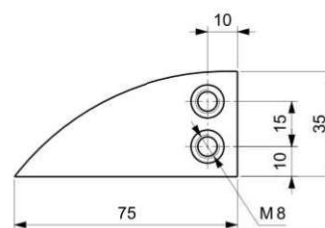

On request, Upper part is available in Self-Lubricating UHMWPE & Oil-filled PA.



PART NUMBER IDENTIFICATION

CURVES	SUPREME -A	NEW e-SLIDE	SUPREME -S
UPPER PART MATERIAL	UHMWPE	High performance Self-lubricating UHMWPE	Oil-filled PA
PART NUMBERS	See table below	Replace "MM" with "MME" Example: 2 tracks, 90° curve angle, P/N: MME02AAY/311	Replace "MM" with "MMP" Example: 2 tracks, 90° curve angle, P/N: MMP02AAY/311



Curve installation
see page 279



Curve material
see page 278

N. OF TRACKS	TOTAL WIDTH W mm	PART NUMBER					
		Curve angle α					
		15°	30°	45°	60°	75°	90°
1	111	MM01AFY/301	MM01AEY/301	MM01ACY/301	MM01ABY/301	MM01ALY/301	MM01AAY/301
2	196	MM02AFY/311	MM02AEY/311	MM02ACY/311	MM02ABY/311	MM02ALY/311	MM02AAY/311
3	281	MM03AFY/311	MM03AEY/311	MM03ACY/311	MM03ABY/311	MM03ALY/311	MM03AAY/311
4	366	MM04AFY/311	MM04AEY/311	MM04ACY/311	MM04ABY/311	MM04ALY/311	MM04AAY/311
5	451	MM05AFY/311	MM05AEY/311	MM05ACY/311	MM05ABY/311	MM05ALY/311	MM05AAY/311
6	536	MM06AFY/311	MM06AEY/311	MM06ACY/311	MM06ABY/311	MM06ALY/311	MM06AAY/311

NOTE: For custom requests with dimensions different from the standard, please refer to page 318.

VERSION M 04

SUITABLE FOR CHAINS:

- 782M K 83,8 (See page 247)
- 783M K 83,8 (See page 247)

RADIUS	BASIC WIDTH	TRANSVERSAL PITCH	INFEED/OUTFEED LENGTH
mm	mm	mm	mm
750	100	85	100



Single track

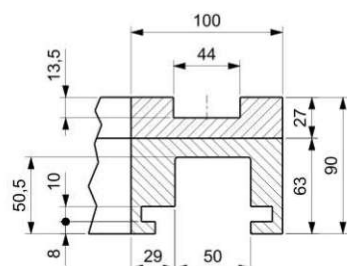

Multi track

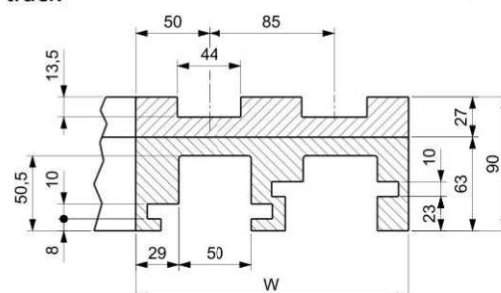

Radius

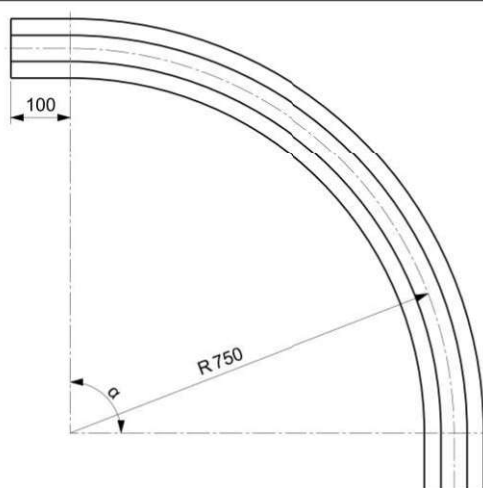

Return guide shoe

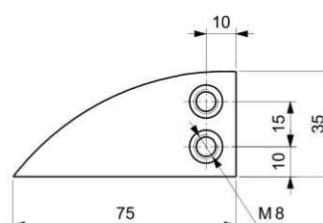

On request, Upper part is available in Self-Lubricating UHMWPE & Oil-filled PA.



PART NUMBER IDENTIFICATION			
CURVES	SUPREME-A	NEW e-SLIDE	SUPREME-S
UPPER PART MATERIAL	UHMWPE	High performance Self-lubricating UHMWPE	Oil-filled PA
PART NUMBERS	See table below	Replace "MM" with "MME" Example: 2 tracks, 90° curve angle, P/N: MME02EAY/111	Replace "MM" with "MMP" Example: 2 tracks, 90° curve angle, P/N: MMP02EAY/111



Curve installation
see page 279



Curve material
see page 278

N. OF TRACKS	TOTAL WIDTH W mm	PART NUMBER					
		Curve angle α					
		15°	30°	45°	60°	75°	90°
1	100	MM01EFY/101	MM01EEY/101	MM01ECY/101	MM01EBY/101	MM01ELY/101	MM01EAY/101
2	185	MM02EFY/111	MM02EEY/111	MM02ECY/111	MM02EBY/111	MM02ELY/111	MM02EAY/111
3	270	MM03EFY/111	MM03EEY/111	MM03ECY/111	MM03EBY/111	MM03ELY/111	MM03EAY/111
4	355	MM04EFY/111	MM04EEY/111	MM04ECY/111	MM04EBY/111	MM04ELY/111	MM04EAY/111
5	440	MM05EFY/111	MM05EEY/111	MM05ECY/111	MM05EBY/111	MM05ELY/111	MM05EAY/111
6	525	MM06EFY/111	MM06EEY/111	MM06ECY/111	MM06EBY/111	MM06ELY/111	MM06EAY/111

NOTE: For custom requests with dimensions different from the standard, please refer to page 318.

VERSION M 05

SUITABLE FOR CHAINS:

- 782M K 83,8 (See page 247)
- 783M K 83,8 (See page 247)

RADIUS	BASIC WIDTH	TRANSVERSAL PITCH	INFEED/OUTFEED LENGTH
mm	mm	mm	mm
750	111	85	100



Single track

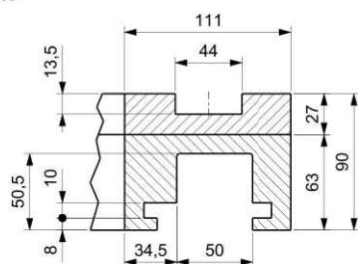

Multi track

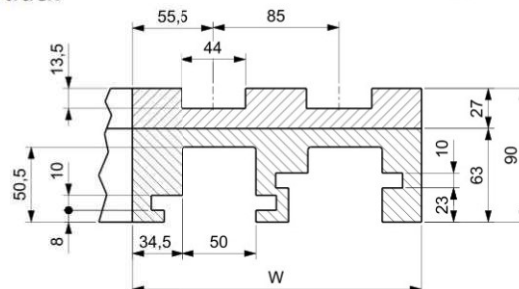

Radius

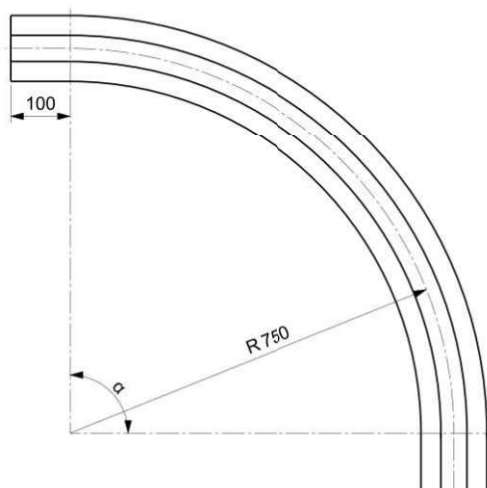

Return guide shoe

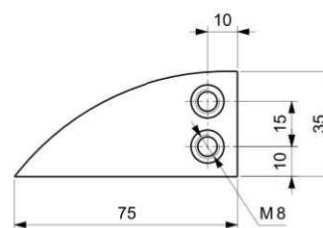

On request, Upper part is available in Self-Lubricating UHMWPE & Oil-filled PA.



PART NUMBER IDENTIFICATION			
CURVES	SUPREME -A	NEW e-SLIDE	SUPREME -S
UPPER PART MATERIAL	UHMWPE	High performance Self-lubricating UHMWPE	Oil-filled PA
PART NUMBERS	See table below	Replace "MM" with "MME" Example: 2 tracks, 90° curve angle, P/N: MME02EAY/311	Replace "MM" with "MMP" Example: 2 tracks, 90° curve angle, P/N: MMP02EAY/311



Curve installation
see page 279



Curve material
see page 278

N. OF TRACKS	TOTAL WIDTH W mm	PART NUMBER					
		Curve angle α					
		15°	30°	45°	60°	75°	90°
1	111	MM01EFY/301	MM01EEY/301	MM01ECY/301	MM01EBY/301	MM01ELY/301	MM01EAY/301
2	196	MM02EFY/311	MM02EEY/311	MM02ECY/311	MM02EBY/311	MM02ELY/311	MM02EAY/311
3	281	MM03EFY/311	MM03EEY/311	MM03ECY/311	MM03EBY/311	MM03ELY/311	MM03EAY/311
4	366	MM04EFY/311	MM04EEY/311	MM04ECY/311	MM04EBY/311	MM04ELY/311	MM04EAY/311
5	451	MM05EFY/311	MM05EEY/311	MM05ECY/311	MM05EBY/311	MM05ELY/311	MM05EAY/311
6	536	MM06EFY/311	MM06EEY/311	MM06ECY/311	MM06EBY/311	MM06ELY/311	MM06EAY/311

NOTE: For custom requests with dimensions different from the standard, please refer to page 318.

VERSION M 06

SUITABLE FOR CHAINS:

- 782M K 83,8 (See page 247)
- 783M K 83,8 (See page 247)

RADIUS	BASIC WIDTH	TRANSVERSAL PITCH	INFEED/OUTFEED LENGTH
mm	mm	mm	mm
1000	100	85	-



Single track

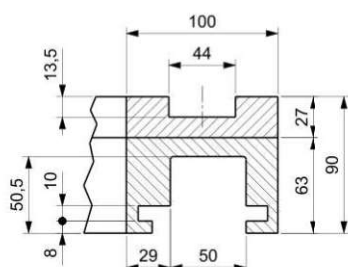

Multi track

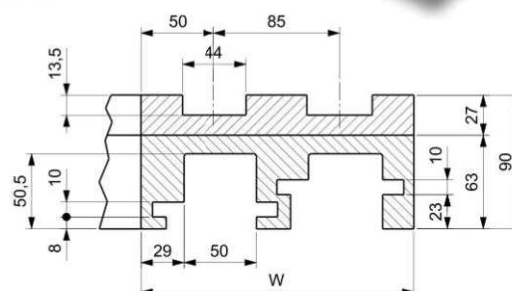

Radius

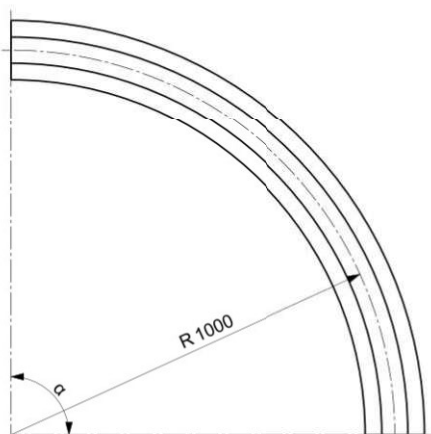

Return guide shoe

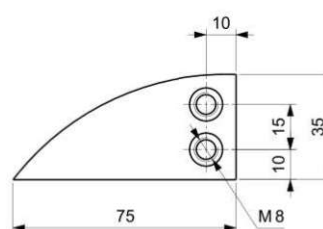

On request, Upper part is available in Self-Lubricating UHMWPE & Oil-filled PA.



PART NUMBER IDENTIFICATION

CURVES	SUPREME - A	NEW e-SLIDE	SUPREME - S
UPPER PART MATERIAL	UHMWPE	High performance Self-lubricating UHMWPE	Oil-filled PA
PART NUMBERS	See table below	Replace "MM" with "MME" Example: 2 tracks, 90° curve angle, P/N: MME02GAY/110	Replace "MM" with "MMP" Example: 2 tracks, 90° curve angle, P/N: MMP02GAY/110



Curve installation
see page 279



Curve material
see page 278

N. OF TRACKS	TOTAL WIDTH W mm	PART NUMBER					
		Curve angle α					
		15°	30°	45°	60°	75°	90°
1	100	MM01GFY/100	MM01GEY/100	MM01GKY/100	MM01GBY/100	MM01GLY/100	MM01GAY/100
2	185	MM02GFY/110	MM02GEY/110	MM02GKY/110	MM02GBY/110	MM02GLY/110	MM02GAY/110
3	270	MM03GFY/110	MM03GEY/110	MM03GKY/110	MM03GBY/110	MM03GLY/110	MM03GAY/110
4	355	MM04GFY/110	MM04GEY/110	MM04GKY/110	MM04GBY/110	MM04GLY/110	MM04GAY/110

NOTE: For custom requests with dimensions different from the standard, please refer to page 318.

VERSION U 01

SUITABLE FOR CHAINS:

-793M K 83,8

(See page 249)

RADIUS	BASIC WIDTH	TRANSVERSAL PITCH	INFEED/ OUTFEED LENGTH
mm	mm	mm	mm
500	100	85	-



Single track

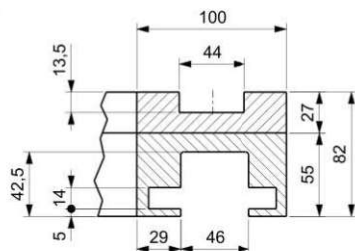

Multi track

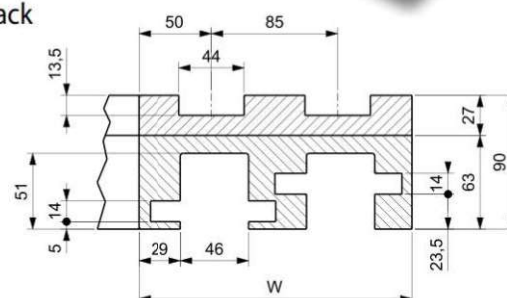

Radius

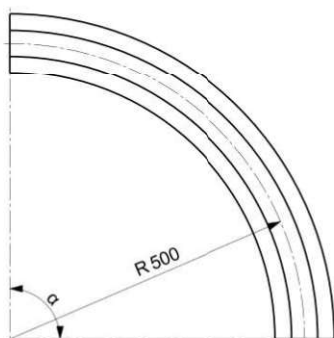

Return guide shoe

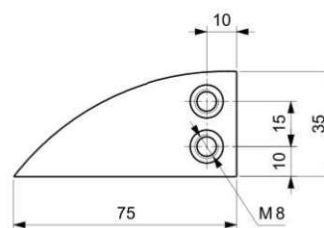

On request, Upper part is available in Self-Lubricating UHMWPE & Oil-filled PA.



PART NUMBER IDENTIFICATION			
CURVES	SUPREME-A	NEW Q-SLIDE	SUPREME-S
UPPER PART MATERIAL	UHMWPE	High performance Self-lubricating UHMWPE	Oil-filled PA
PART NUMBERS	See table below	Replace "MU" with "MUE" Example: 2 tracks, 90° curve angle, P/N: MUE02AAY/110	Replace "MU" with "MUP" Example: 2 tracks, 90° curve angle, P/N: MUP02AAY/110



Curve installation
see page 279



Curve material
see page 278

N. OF TRACKS	TOTAL WIDTH W mm	PART NUMBER					
		Curve angle α					
		15°	30°	45°	60°	75°	90°
1	100	MU01AFX/100	MU01AEX/100	MU01ACX/100	MU01ABX/100	MU01ALX/100	MU01AAX/100
2	185	MU02AFY/110	MU02AEX/110	MU02ACY/110	MU02ABY/110	MU02ALY/110	MU02AAY/110
3	270	MU03AFY/110	MU03AEX/110	MU03ACY/110	MU03ABY/110	MU03ALY/110	MU03AAY/110
4	355	MU04AFY/110	MU04AEX/110	MU04ACY/110	MU04ABY/110	MU04ALY/110	MU04AAY/110
5	440	MU05AFY/110	MU05AEX/110	MU05ACY/110	MU05ABY/110	MU05ALY/110	MU05AAY/110
6	525	MU06AFY/110	MU06AEX/110	MU06ACY/110	MU06ABY/110	MU06ALY/110	MU06AAY/110

NOTE: For custom requests with dimensions different from the standard, please refer to page 318.

VERSION U 02

SUITABLE FOR CHAINS:

-793M K 83,8

(See page 249)

RADIUS	BASIC WIDTH	TRANSVERSAL PITCH	INFEED/OUTFEED LENGTH
mm	mm	mm	mm
500	100	85	100



Single track

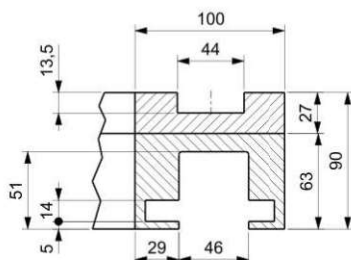

Multi track

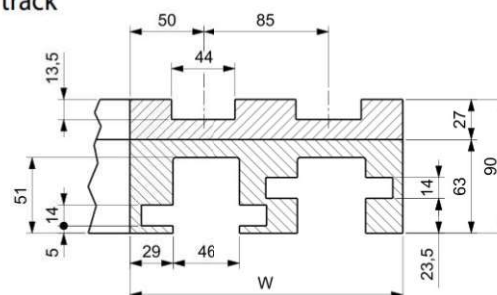

Radius

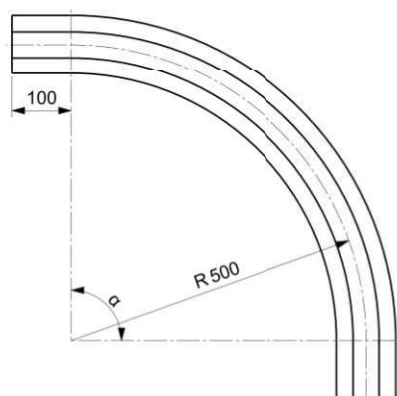

Return guide shoe

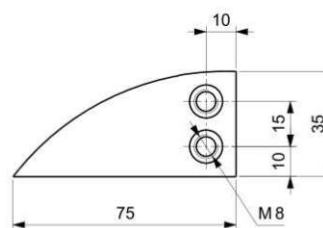

On request, Upper part is available in Self-Lubricating UHMWPE & Oil-filled PA.



PART NUMBER IDENTIFICATION			
CURVES	SUPREME -A	NEW e-SLIDE	SUPREME -S
UPPER PART MATERIAL	UHMWPE	High performance Self-lubricating UHMWPE	Oil-filled PA
PART NUMBERS	See table below	Replace "MU" with "MUE" Example: 2 tracks, 90° curve angle, P/N: MUE02AAY/111	Replace "MU" with "MUP" Example: 2 tracks, 90° curve angle, P/N: MUP02AAY/111



Curve installation
see page 279



Curve material
see page 278

N. OF TRACKS	TOTAL WIDTH W mm	PART NUMBER					
		Curve angle α					
		15°	30°	45°	60°	75°	90°
1	100	MU01AFY/101	MU01AEY/101	MU01ACY/101	MU01ABY/101	MU01ALY/101	MU01AAY/101
2	185	MU02AFY/111	MU02AEY/111	MU02ACY/111	MU02ABY/111	MU02ALY/111	MU02AAY/111
3	270	MU03AFY/111	MU03AEY/111	MU03ACY/111	MU03ABY/111	MU03ALY/111	MU03AAY/111
4	355	MU04AFY/111	MU04AEY/111	MU04ACY/111	MU04ABY/111	MU04ALY/111	MU04AAY/111
5	440	MU05AFY/111	MU05AEY/111	MU05ACY/111	MU05ABY/111	MU05ALY/111	MU05AAY/111
6	525	MU06AFY/111	MU06AEY/111	MU06ACY/111	MU06ABY/111	MU06ALY/111	MU06AAY/111

NOTE: For custom requests with dimensions different from the standard, please refer to page 318.

VERSION U 03

SUITABLE FOR CHAINS:

-793M K 83,8

(See page 249)

RADIUS	BASIC WIDTH	TRANSVERSAL PITCH	INFEED/OUTFEED LENGTH
mm	mm	mm	mm
500	111	85	100



Single track

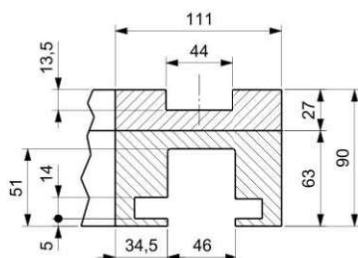

Multi track

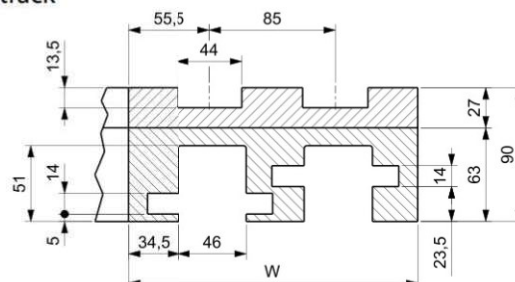

Radius

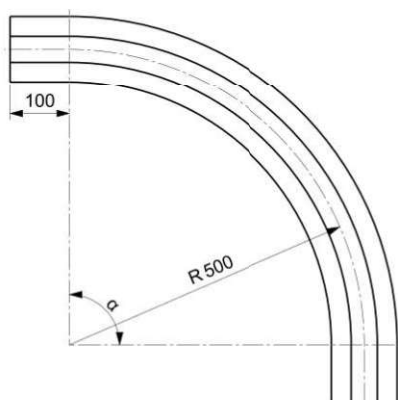

Return guide shoe

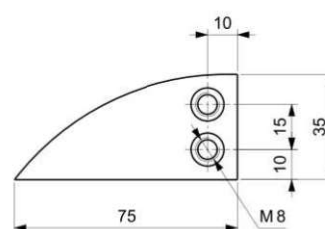

On request, Upper part is available in Self-Lubricating UHMWPE & Oil-filled PA.



PART NUMBER IDENTIFICATION

CURVES	SUPREME -A	NEW e-SLIDE	SUPREME -S
UPPER PART MATERIAL	UHMWPE	High performance Self-lubricating UHMWPE	Oil-filled PA
PART NUMBERS	See table below	Replace "MU" with "MUE" Example: 2 tracks, 90° curve angle, P/N: MUE02AAY/311	Replace "MU" with "MUP" Example: 2 tracks, 90° curve angle, P/N: MUP02AAY/311



Curve installation
see page 279



Curve material
see page 278

N. OF TRACKS	TOTAL WIDTH W mm	PART NUMBER					
		Curve angle α					
		15°	30°	45°	60°	75°	90°
1	111	MU01AFY/301	MU01AEY/301	MU01ACY/301	MU01ABY/301	MU01ALY/301	MU01AAY/301
2	196	MU02AFY/311	MU02AEY/311	MU02ACY/311	MU02ABY/311	MU02ALY/311	MU02AAY/311
3	281	MU03AFY/311	MU03AEY/311	MU03ACY/311	MU03ABY/311	MU03ALY/311	MU03AAY/311
4	366	MU04AFY/311	MU04AEY/311	MU04ACY/311	MU04ABY/311	MU04ALY/311	MU04AAY/311
5	451	MU05AFY/311	MU05AEY/311	MU05ACY/311	MU05ABY/311	MU05ALY/311	MU05AAY/311
6	536	MU06AFY/311	MU06AEY/311	MU06ACY/311	MU06ABY/311	MU06ALY/311	MU06AAY/311

NOTE: For custom requests with dimensions different from the standard, please refer to page 318.

VERSION U 04

SUITABLE FOR CHAINS:

-793M K 83,8

(See page 249)

RADIUS	BASIC WIDTH	TRANSVERSAL PITCH	INFEED/OUTFEED LENGTH
mm	mm	mm	mm
750	100	85	100



Single track

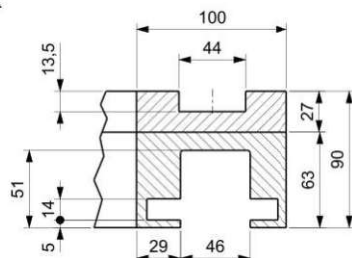

Multi track

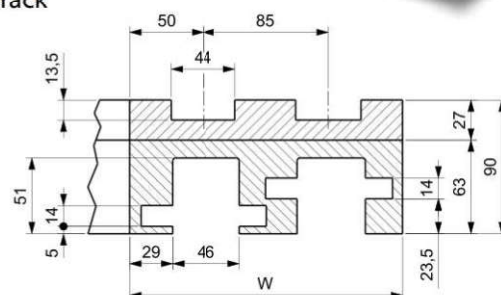

Radius

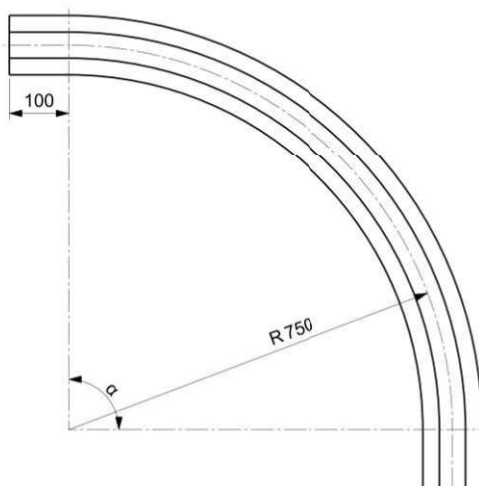

Return guide shoe

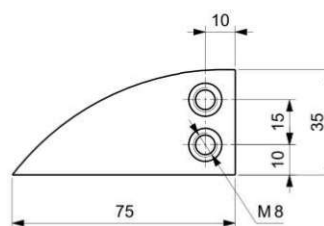

On request, Upper part is available in Self-Lubricating UHMWPE & Oil-filled PA.



PART NUMBER IDENTIFICATION

CURVES	SUPREME -A	NEW e-SLIDE	SUPREME -S
UPPER PART MATERIAL	UHMWPE	High performance Self-lubricating UHMWPE	Oil-filled PA
PART NUMBERS	See table below	Replace "MU" with "MUE" Example: 2 tracks, 90° curve angle, P/N: MUE02EAY/111	Replace "MU" with "MUP" Example: 2 tracks, 90° curve angle, P/N: MUP02EAY/111



Curve installation
see page 279



Curve material
see page 278

N. OF TRACKS	TOTAL WIDTH W mm	PART NUMBER					
		Curve angle α					
		15°	30°	45°	60°	75°	90°
1	100	MU01EFY/101	MU01EY/101	MU01ECY/101	MU01EBY/101	MU01ELY/101	MU01EAY/101
2	185	MU02EFY/111	MU02EY/111	MU02ECY/111	MU02EBY/111	MU02ELY/111	MU02EAY/111
3	270	MU03EFY/111	MU03EY/111	MU03ECY/111	MU03EBY/111	MU03ELY/111	MU03EAY/111
4	355	MU04EFY/111	MU04EY/111	MU04ECY/111	MU04EBY/111	MU04ELY/111	MU04EAY/111
5	440	MU05EFY/111	MU05EY/111	MU05ECY/111	MU05EBY/111	MU05ELY/111	MU05EAY/111
6	525	MU06EFY/111	MU06EY/111	MU06ECY/111	MU06EBY/111	MU06ELY/111	MU06EAY/111

NOTE: For custom requests with dimensions different from the standard, please refer to page 318.

VERSION U 05

SUITABLE FOR CHAINS:

-793M K 83,8

(See page 249)

RADIUS	BASIC WIDTH	TRANSVERSAL PITCH	INFEED/OUTFEED LENGTH
mm	mm	mm	mm
1000	100	85	-



Single track

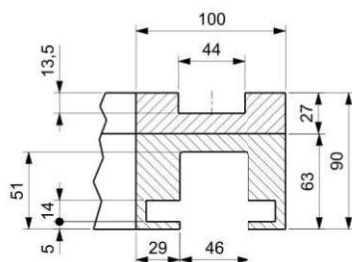

Multi track

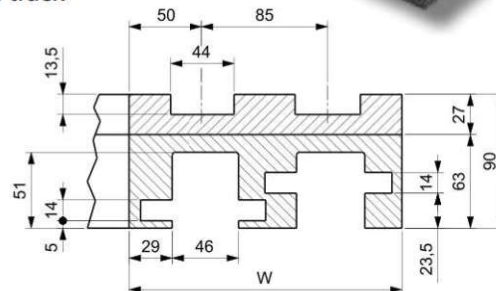

Radius

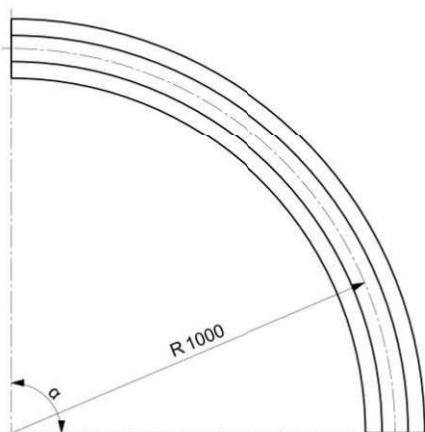

Return guide shoe

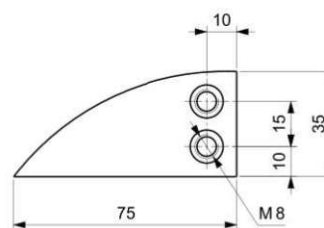

On request, Upper part is available in Self-Lubricating UHMWPE & Oil-filled PA.



PART NUMBER IDENTIFICATION			
CURVES			
UPPER PART MATERIAL	UHMWPE	High performance Self-lubricating UHMWPE	Oil-filled PA
PART NUMBERS	See table below	Replace "MU" with "MUE" Example: 2 tracks, 90° curve angle, P/N: MUE02GAY/110	Replace "MU" with "MUD" Example: 2 tracks, 90° curve angle, P/N: MUD02GAY/110



Curve installation
see page 279



Curve material
see page 278

N. OF TRACKS	TOTAL WIDTH W mm	PART NUMBER					
		Curve angle α					
		15°	30°	45°	60°	75°	90°
1	100	MU01GFY/100	MU01GEY/100	MU01GKY/100	MU01GBY/100	MU01GLY/100	MU01GAY/100
2	185	MU02GFY/110	MU02GEY/110	MU02GKY/110	MU02GBY/110	MU02GLY/110	MU02GAY/110
3	270	MU03GFY/110	MU03GEY/110	MU03GKY/110	MU03GBY/110	MU03GLY/110	MU03GAY/110
4	355	MU04GFY/110	MU04GEY/110	MU04GKY/110	MU04GBY/110	MU04GLY/110	MU04GAY/110

NOTE: For custom requests with dimensions different from the standard, please refer to page 318.

VERSION U 06

SUITABLE FOR CHAINS:

-793M K 4½

(See page 249)

RADIUS	BASIC WIDTH	TRANSVERSAL PITCH	INFEED/OUTFEED LENGTH
mm	mm	mm	mm
500	129	120	125



Single track

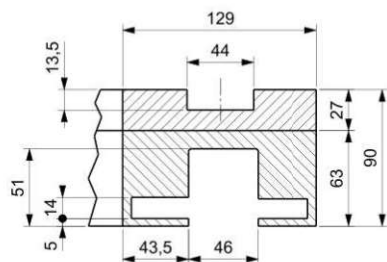

Multi track

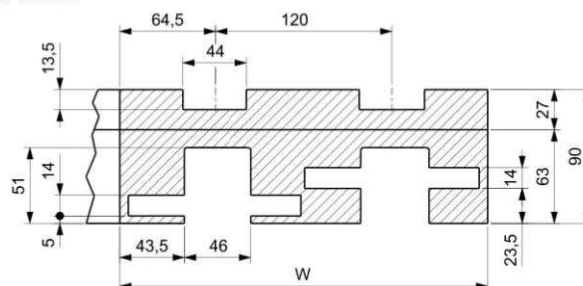

Radius

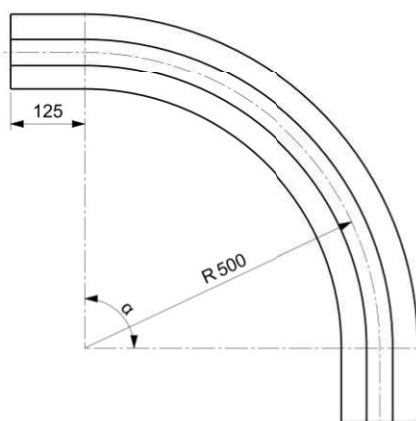

Return guide shoe

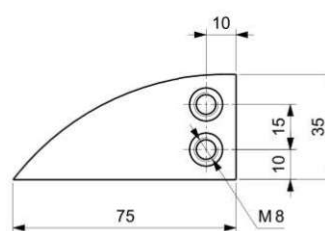

On request, Upper part is available in Self-Lubricating UHMWPE & Oil-filled PA.



PART NUMBER IDENTIFICATION			
CURVES	SUPREME -A	NEW e-SLIDE	SUPREME -S
UPPER PART MATERIAL	UHMWPE	High performance Self-lubricating UHMWPE	Oil-filled PA
PART NUMBERS	See table below	Replace "MU" with "MUE" Example: 2 tracks, 90° curve angle, P/N: MUE02AAY/442	Replace "MU" with "MUP" Example: 2 tracks, 90° curve angle, P/N: MUP02AAY/442



Curve installation
see page 279



Curve material
see page 278

N. OF TRACKS	TOTAL WIDTH W mm	PART NUMBER					
		Curve angle α					
		15°	30°	45°	60°	75°	90°
1	129	MU01AFY/402	MU01AEY/402	MU01ACY/402	MU01ABY/402	MU01ALY/402	MU01AAY/402
2	249	MU02AFY/442	MU02AEY/442	MU02ACY/442	MU02ABY/442	MU02ALY/442	MU02AAY/442
3	369	MU03AFY/442	MU03AEY/442	MU03ACY/442	MU03ABY/442	MU03ALY/442	MU03AAY/442
4	489	MU04AFY/442	MU04AEY/442	MU04ACY/442	MU04ABY/442	MU04ALY/442	MU04AAY/442

NOTE: For custom requests with dimensions different from the standard, please refer to page 318.

On request, Magnetic curves with dimensions different from the standard can be supplied.
Please fill the form below with the requested parameters and contact REGINA customer service.

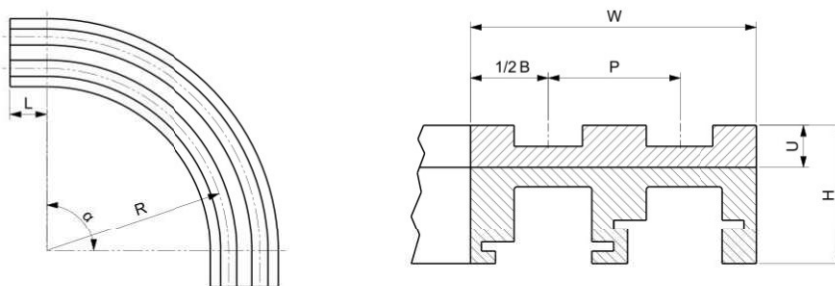

FOR CHAIN SERIES:	REQUESTED CURVE PARAMETERS		
CHAIN WIDTH:	mm	inch	°
FIRST RADIUS R:			
CURVE ANGLE α :			
N. OF TRACKS:			
TRANSVERSAL PITCH P:			
BASIC WIDTH B:			
TOTAL WIDTH W:			
INFEED LENGTH L:			



***FliteTop*® Matveyor®**

**TAB, Bevel and
Low Pin Center Curves**

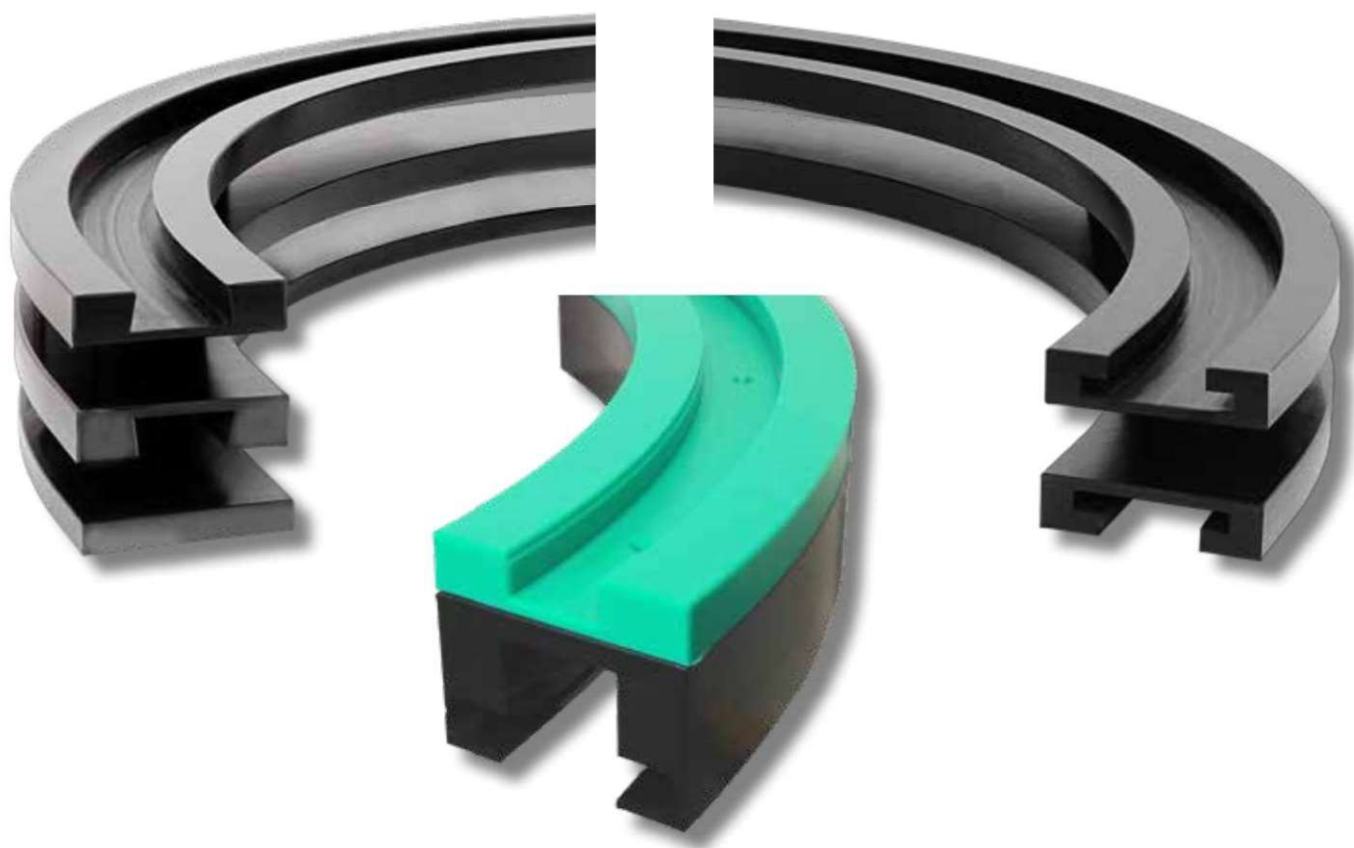

For FliteTop® & Matveyor® SIDEFLEXING CHAINS

TAB curves include both upper and return part.

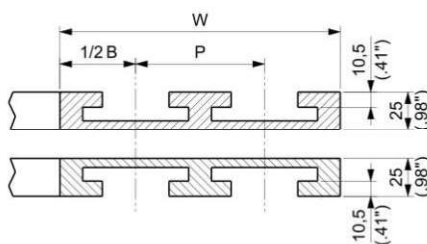
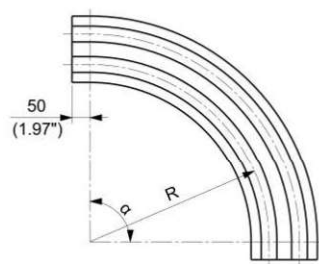

CHAIN WIDTH	TRANSVERSAL PITCH P	BASIC WIDTH B
mm	inch	mm
3 1/4" 83,8 mm	85 3.35	100 3.94
4 1/2" 120	4.72	130 5.12
7 1/2" 195	7.68	200 7.87

On request, Upper part is available in Self-Lubricating UHMWPE & Oil-filled PA.



Curve material see page 14

PART NUMBER IDENTIFICATION			
CURVES	UHMWPE	NEW e-SLIDE	SUPREME-S
UPPER PART MATERIAL	UHMWPE	High performance Self-lubricating UHMWPE	Oil-filled PA
PART NUMBERS	See table below	Replace "T80" with "T80E" Example: Radius 500 mm, 1 track, 90° curve angle for 880T chain, P/N: T80FKD1A/1000	Replace "T80" with "T80P" Example: Radius 500 mm, 1 track, 90° curve angle for 880T chain, P/N: T80PKD1A/1000

CHAIN TYPE		RADIUS* R		N. OF TRACKS	TOTAL WIDTH W		PART NUMBER							
Series	Width	mm	inch		mm	inch	Curve angle α							
878T	3 1/4"	200	7.874	1	100	3.937	T80KD1D/1F00	T80KD1D/1E00	T80KD1D/1C00	T80KD1D/1B00	T80KD1D/1L00	T80KD1D/1000		
982T														
PHDG 981T	457,2	18		1	100	3.937	T80KD10/1F00	T80KD10/1E00	T80KD10/1C00	T80KD10/1B00	T80KD10/1L00	T80KD10/1000		
				2	185	7.283	T80KD20/1F00	T80KD20/1E00	T80KD20/1C00	T80KD20/1B00	T80KD20/1L00	T80KD20/1000		
				3	270	10.630	T80KD30/1F00	T80KD30/1E00	T80KD30/1C00	T80KD30/1B00	T80KD30/1L00	T80KD30/1000		
				4	355	13.189	T80KD40/1F00	T80KD40/1E00	T80KD40/1C00	T80KD40/1B00	T80KD40/1L00	T80KD40/1000		
				5	440	15.748	T80KD50/1F00	T80KD50/1E00	T80KD50/1C00	T80KD50/1B00	T80KD50/1L00	T80KD50/1000		
HFX 880T	500	19.685		1	100	3.937	T80KD1A/1F00	T80KD1A/1E00	T80KD1A/1C00	T80KD1A/1B00	T80KD1A/1L00	T80KD1A/1000		
				2	185	7.283	T80KD2A/1F00	T80KD2A/1E00	T80KD2A/1C00	T80KD2A/1B00	T80KD2A/1L00	T80KD2A/1000		
				3	270	10.630	T80KD3A/1F00	T80KD3A/1E00	T80KD3A/1C00	T80KD3A/1B00	T80KD3A/1L00	T80KD3A/1000		
				4	355	13.189	T80KD4A/1F00	T80KD4A/1E00	T80KD4A/1C00	T80KD4A/1B00	T80KD4A/1L00	T80KD4A/1000		
				5	440	15.748	T80KD5A/1F00	T80KD5A/1E00	T80KD5A/1C00	T80KD5A/1B00	T80KD5A/1L00	T80KD5A/1000		
880TA														
880T	3 1/4"	610	24.016	1	100	3.937	T80KD1C/1F00	T80KD1C/1E00	T80KD1C/1C00	T80KD1C/1B00	T80KD1C/1L00	T80KD1C/1000		
				2	185	7.283	T80KD2C/1F00	T80KD2C/1E00	T80KD2C/1C00	T80KD2C/1B00	T80KD2C/1L00	T80KD2C/1000		
				3	270	10.630	T80KD3C/1F00	T80KD3C/1E00	T80KD3C/1C00	T80KD3C/1B00	T80KD3C/1L00	T80KD3C/1000		
				4	355	13.189	T80KD4C/1F00	T80KD4C/1E00	T80KD4C/1C00	T80KD4C/1B00	T80KD4C/1L00	T80KD4C/1000		
				5	440	15.748	T80KD5C/1F00	T80KD5C/1E00	T80KD5C/1C00	T80KD5C/1B00	T80KD5C/1L00	T80KD5C/1000		
879T	83.8 mm													
881T														
981T	800	31.496		1	100	3.937	T80KD1T/1F00	T80KD1T/1E00	T80KD1T/1C00	T80KD1T/1B00	T80KD1T/1L00	T80KD1T/1000		
				2	185	7.283	T80KD2T/1F00	T80KD2T/1E00	T80KD2T/1C00	T80KD2T/1B00	T80KD2T/1L00	T80KD2T/1000		
				3	270	10.630	T80KD3T/1F00	T80KD3T/1E00	T80KD3T/1C00	T80KD3T/1B00	T80KD3T/1L00	T80KD3T/1000		
				4	355	13.189	T80KD4T/1F00	T80KD4T/1E00	T80KD4T/1C00	T80KD4T/1B00	T80KD4T/1L00	T80KD4T/1000		
				5	440	15.748	T80KD5T/1F00	T80KD5T/1E00	T80KD5T/1C00	T80KD5T/1B00	T80KD5T/1L00	T80KD5T/1000		
783T														
793T	1000	39.370		1	100	3.937	T80KD1G/1F00	T80KD1G/1E00	T80KD1G/1C00	T80KD1G/1B00	T80KD1G/1L00	T80KD1G/1000		
				2	185	7.283	T80KD2G/1F00	T80KD2G/1E00	T80KD2G/1C00	T80KD2G/1B00	T80KD2G/1L00	T80KD2G/1000		
				3	270	10.630	T80KD3G/1F00	T80KD3G/1E00	T80KD3G/1C00	T80KD3G/1B00	T80KD3G/1L00	T80KD3G/1000		
				4	355	13.189	T80KD4G/1F00	T80KD4G/1E00	T80KD4G/1C00	T80KD4G/1B00	T80KD4G/1L00	T80KD4G/1000		
				5	440	15.748	T80KD5G/1F00	T80KD5G/1E00	T80KD5G/1C00	T80KD5G/1B00	T80KD5G/1L00	T80KD5G/1000		
981T														
880T														
HFX 880T	4 1/2"	800	31.496	1	130	5.118	T80KG1C/1F00	T80KG1C/1E00	T80KG1C/1C00	T80KG1C/1B00	T80KG1C/1L00	T80KG1C/1000		
				2	250	9.843	T80KG2C/1F00	T80KG2C/1E00	T80KG2C/1C00	T80KG2C/1B00	T80KG2C/1L00	T80KG2C/1000		
				1	130	5.118	T80KG1T/1F00	T80KG1T/1E00	T80KG1T/1C00	T80KG1T/1B00	T80KG1T/1L00	T80KG1T/1000		
				2	250	9.843	T80KG2T/1F00	T80KG2T/1E00	T80KG2T/1C00	T80KG2T/1B00	T80KG2T/1L00	T80KG2T/1000		
				1	130	5.118	T80KG1G/1F00	T80KG1G/1E00	T80KG1G/1C00	T80KG1G/1B00	T80KG1G/1L00	T80KG1G/1000		
783T														
793T	1000	39.370		2	250	9.843	T80KG2G/1F00	T80KG2G/1E00	T80KG2G/1C00	T80KG2G/1B00	T80KG2G/1L00	T80KG2G/1000		
				1	200	7.874	T80KL1C/1F00	T80KL1C/1E00	T80KL1C/1C00	T80KL1C/1B00	T80KL1C/1L00	T80KL1C/1000		
				2	395	15.551	T80KL2C/1F00	T80KL2C/1E00	T80KL2C/1C00	T80KL2C/1B00	T80KL2C/1L00	T80KL2C/1000		
				1	200	7.874	T80KL1T/1F00	T80KL1T/1E00	T80KL1T/1C00	T80KL1T/1B00	T80KL1T/1L00	T80KL1T/1000		
				2	395	15.551	T80KL2T/1F00	T80KL2T/1E00	T80KL2T/1C00	T80KL2T/1B00	T80KL2T/1L00	T80KL2T/1000		
881T														
981T	7 1/2"	800	31.496	1	200	7.874	T80KL1G/1F00	T80KL1G/1E00	T80KL1G/1C00	T80KL1G/1B00	T80KL1G/1L00	T80KL1G/1000		
				2	395	15.551	T80KL2G/1F00	T80KL2G/1E00	T80KL2G/1C00	T80KL2G/1B00	T80KL2G/1L00	T80KL2G/1000		
				1	200	7.874	T80KL1G/1F00	T80KL1G/1E00	T80KL1G/1C00	T80KL1G/1B00	T80KL1G/1L00	T80KL1G/1000		
				2	395	15.551	T80KL2G/1F00	T80KL2G/1E00	T80KL2G/1C00	T80KL2G/1B00	T80KL2G/1L00	T80KL2G/1000		
				1	200	7.874	T80KL1G/1F00	T80KL1G/1E00	T80KL1G/1C00	T80KL1G/1B00	T80KL1G/1L00	T80KL1G/1000		

* First track is intended.

NOTE: for custom requests with dimensions different from the standard, please refer to page 323.

For FliteTop® SIDEFLEXING CHAINS

TAB curves include both upper and return part.

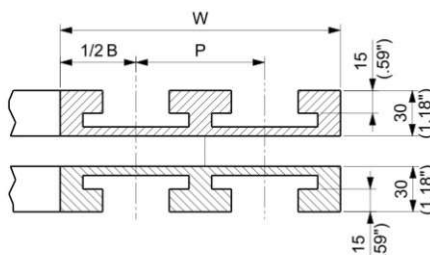
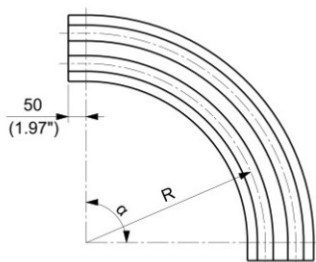

CHAIN WIDTH	TRANSVERSAL PITCH P	BASIC WIDTH B
	mm inch	mm inch
3 3/4"		110 4.33
4 1/2"		130 5.12
6"	Single track	170 6.69
7 1/2"		200 7.87
10"		270 10.63
12"		320 12.60

On request, Upper part is available in Self-Lubricating UHMWPE & Oil-filled PA.



PART NUMBER IDENTIFICATION			
CURVES	UHMWPE	NEW e-SLIDE	SUPREME-S
UPPER PART MATERIAL	UHMWPE	High performance Self-lubricating UHMWPE	Oil-filled PA
PART NUMBERS	See table below	Replace "T82" with "T82E" Example: Radius 700 mm, 1 track, 90° curve angle for LBP 882T K 3 3/4 chain, P/N: T82EKEA1Z/1000	Replace "T82" with "T82P" Example: Radius 700 mm, 1 track, 90° curve angle for LBP 882T K 3 3/4 chain, P/N: T82PKEA1Z/1000



Curve material see page 14

CHAIN TYPE		RADIUS R		N. OF TRACKS	TOTAL WIDTH W		PART NUMBER Curve angle α					
Series	Width	mm	inch		mm	inch	15°	30°	45°	60°	75°	90°
LBP 882T	3 ¾"	700	27.559	1	110	4.331	T82KEA1Z/1F00	T82KEA1Z/1E00	T82KEA1Z/1C00	T82KEA1Z/1B00	T82KEA1Z/1L00	T82KEA1Z/1000
882T		610	24.016	1	130	5.118	T82KG1C/1F00	T82KG1C/1E00	T82KG1C/1C00	T82KG1C/1B00	T82KG1C/1L00	T82KG1C/1000
HFX 882T	4 ½"	800	31.496	1	130	5.118	T82KG1T/1F00	T82KG1T/1E00	T82KG1T/1C00	T82KG1T/1B00	T82KG1T/1L00	T82KG1T/1000
LBP 882T		1000	39.370	1	130	5.118	T82KG1G/1F00	T82KG1G/1E00	T82KG1G/1C00	T82KG1G/1B00	T82KG1G/1L00	T82KG1G/1000
882T	6"	610	24.016	1	170	6.69	T82KH1C/1F00	T82KH1C/1E00	T82KH1C/1C00	T82KH1C/1B00	T82KH1C/1L00	T82KH1C/1000
		800	31.496	1	170	6.69	T82KH1T/1F00	T82KH1T/1E00	T82KH1T/1C00	T82KH1T/1B00	T82KH1T/1L00	T82KH1T/1000
		1000	39.370	1	170	6.69	T82KH1G/1F00	T82KH1G/1E00	T82KH1G/1C00	T82KH1G/1B00	T82KH1G/1L00	T82KH1G/1000
882T		610	24.016	1	200	7.874	T82KL1C/1F00	T82KL1C/1E00	T82KL1C/1C00	T82KL1C/1B00	T82KL1C/1L00	T82KL1C/1000
HFX 882T	7 ½"	800	31.496	1	200	7.874	T82KL1T/1F00	T82KL1T/1E00	T82KL1T/1C00	T82KL1T/1B00	T82KL1T/1L00	T82KL1T/1000
LBP 882T		1000	39.370	1	200	7.874	T82KL1G/1F00	T82KL1G/1E00	T82KL1G/1C00	T82KL1G/1B00	T82KL1G/1L00	T82KL1G/1000
882T		610	24.016	1	270	10.630	T82KM1C/1F00	T82KM1C/1E00	T82KM1C/1C00	T82KM1C/1B00	T82KM1C/1L00	T82KM1C/1000
HFX 882T	10"	800	31.496	1	270	10.630	T82KM1T/1F00	T82KM1T/1E00	T82KM1T/1C00	T82KM1T/1B00	T82KM1T/1L00	T82KM1T/1000
LBP 882T		1000	39.370	1	270	10.630	T82KM1G/1F00	T82KM1G/1E00	T82KM1G/1C00	T82KM1G/1B00	T82KM1G/1L00	T82KM1G/1000
882T		610	24.016	1	320	12.598	T82KN1C/1F00	T82KN1C/1E00	T82KN1C/1C00	T82KN1C/1B00	T82KN1C/1L00	T82KN1C/1000
HFX 882T	12"	800	31.496	1	320	12.598	T82KN1T/1F00	T82KN1T/1E00	T82KN1T/1C00	T82KN1T/1B00	T82KN1T/1L00	T82KN1T/1000
LBP 882T		1000	39.370	1	320	12.598	T82KN1G/1F00	T82KN1G/1E00	T82KN1G/1C00	T82KN1G/1B00	T82KN1G/1L00	T82KN1G/1000

NOTE: for custom requests with dimensions different from the standard, please refer to page 323.

For FliteTop® SIDEFLEXING CHAINS

TAB curves include both upper and return part.

FOR 1843T CHAIN

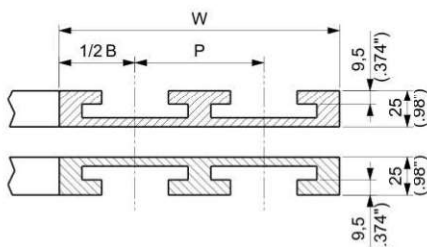

FOR 1701T CHAIN

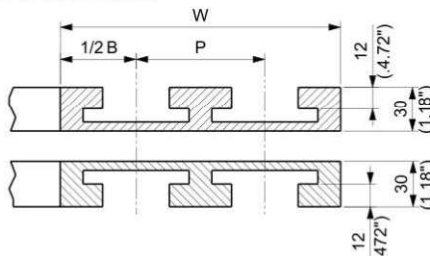

FOR ALL OTHER CHAINS

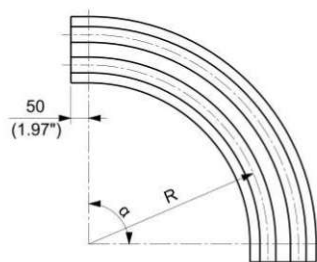
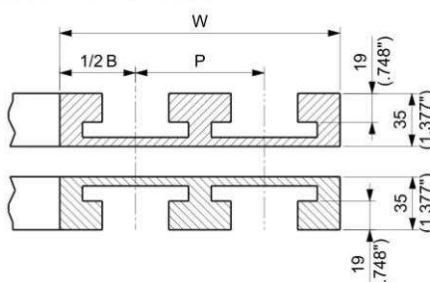

CHAIN WIDTH	TRANSVERSAL PITCH P	BASIC WIDTH B
	mm inch	mm inch
1 1/4"		50 1.97
53mm		100 3.94
2 1/4"		75 2.95
3 1/4"		100 3.94
4 1/2"	Single track	130 5.12
6"		170 6.69
7 1/2"		200 7.87
10"		270 10.63
12"		320 12.60
16"		420 16.54

On request, Upper part is available in Self-Lubricating UHMWPE & Oil-filled PA.



Curve material see page 14

PART NUMBER IDENTIFICATION

CURVES	UHMWPE	NEW e-SLIDE	SUPREME -S
UPPER PART MATERIAL	UHMWPE	High performance Self-lubricating UHMWPE	Oil-filled PA
PART NUMBERS	See table below	Replace "T73" with "T73E" Replace "T43" with "T43E" Replace "T17" with "T17E" Example: Radius 500 mm, 1 track, 90° curve angle for 1863T K 2 1/4" chain, P/N: T73KS1A/1000	Replace "T73" with "T73P" Replace "T43" with "T43P" Replace "T17" with "T17P" Example: Radius 500 mm, 1 track, 90° curve angle for 1863T K 2 1/4" chain, P/N: T73KS1A/1000

CHAIN TYPE		RADIUS R		N. OF TRACKS	TOTAL WIDTH W		PART NUMBER Curve angle α						
Series	Width	mm	inch		mm	inch	Curve angle α						
							15°	30°	45°	60°	75°	90°	
1863T	2 1/4"	500	19.685	1	75	2.95	T73KS1A/1F00	T73KS1A/1E00	T73KS1A/1C00	T73KS1A/1B00	T73KS1A/1L00	T73KS1A/1000	
1874T		500	19.685	1	100	3.94	T73KD1A/1F00	T73KD1A/1E00	T73KD1A/1C00	T73KD1A/1B00	T73KD1A/1L00	T73KD1A/1000	
1863T	3 1/4"	610	24.016	1	100	3.94	T73KD1C/1F00	T73KD1C/1E00	T73KD1C/1C00	T73KD1C/1B00	T73KD1C/1L00	T73KD1C/1000	
1873T		800	31.496	1	100	3.94	T73KD1T/1F00	T73KD1T/1E00	T73KD1T/1C00	T73KD1T/1B00	T73KD1T/1L00	T73KD1T/1000	
HFX 1873T		1000	39.370	1	100	3.94	T73KD1G/1F00	T73KD1G/1E00	T73KD1G/1C00	T73KD1G/1B00	T73KD1G/1L00	T73KD1G/1000	
1874T		610	24.016	1	130	5.12	T73KG1C/1F00	T73KG1C/1E00	T73KG1C/1C00	T73KG1C/1B00	T73KG1C/1L00	T73KG1C/1000	
1863T	4 1/2"	800	31.496	1	130	5.12	T73KG1T/1F00	T73KG1T/1E00	T73KG1T/1C00	T73KG1T/1B00	T73KG1T/1L00	T73KG1T/1000	
1873T		1000	39.370	1	130	5.12	T73KG1G/1F00	T73KG1G/1E00	T73KG1G/1C00	T73KG1G/1B00	T73KG1G/1L00	T73KG1G/1000	
HFX 1873T		1000	39.370	1	130	5.12	T73KG1G/1F00	T73KG1G/1E00	T73KG1G/1C00	T73KG1G/1B00	T73KG1G/1L00	T73KG1G/1000	
1874T	6"	500	19.685	1	170	6.69	T73KH1A/1F00	T73KH1A/1E00	T73KH1A/1C00	T73KH1A/1B00	T73KH1A/1L00	T73KH1A/1000	
1873T			500	19.685	1	170	6.69	T73KH1A/1F00	T73KH1A/1E00	T73KH1A/1C00	T73KH1A/1B00	T73KH1A/1L00	T73KH1A/1000
HFX 1873T			500	19.685	1	170	6.69	T73KH1A/1F00	T73KH1A/1E00	T73KH1A/1C00	T73KH1A/1B00	T73KH1A/1L00	T73KH1A/1000
1874T		610	24.016	1	200	7.87	T73KL1C/1F00	T73KL1C/1E00	T73KL1C/1C00	T73KL1C/1B00	T73KL1C/1L00	T73KL1C/1000	
1863T	7 1/2"	800	31.496	1	200	7.87	T73KL1T/1F00	T73KL1T/1E00	T73KL1T/1C00	T73KL1T/1B00	T73KL1T/1L00	T73KL1T/1000	
1873T		1000	39.370	1	200	7.87	T73KL1G/1F00	T73KL1G/1E00	T73KL1G/1C00	T73KL1G/1B00	T73KL1G/1L00	T73KL1G/1000	
HFX 1873T		1000	39.370	1	200	7.87	T73KL1G/1F00	T73KL1G/1E00	T73KL1G/1C00	T73KL1G/1B00	T73KL1G/1L00	T73KL1G/1000	
1873T	10"	610	24.016	1	270	10.63	T73KM1C/1F00	T73KM1C/1E00	T73KM1C/1C00	T73KM1C/1B00	T73KM1C/1L00	T73KM1C/1000	
HFX 1873T		800	31.496	1	270	10.63	T73KM1T/1F00	T73KM1T/1E00	T73KM1T/1C00	T73KM1T/1B00	T73KM1T/1L00	T73KM1T/1000	
		1000	39.370	1	270	10.63	T73KM1G/1F00	T73KM1G/1E00	T73KM1G/1C00	T73KM1G/1B00	T73KM1G/1L00	T73KM1G/1000	
1863T	12"	610	24.016	1	320	12.60	T73KN1C/1F00	T73KN1C/1E00	T73KN1C/1C00	T73KN1C/1B00	T73KN1C/1L00	T73KN1C/1000	
1873T		800	31.496	1	320	12.60	T73KN1T/1F00	T73KN1T/1E00	T73KN1T/1C00	T73KN1T/1B00	T73KN1T/1L00	T73KN1T/1000	
HFX 1873T		1000	39.370	1	320	12.60	T73KN1G/1F00	T73KN1G/1E00	T73KN1G/1C00	T73KN1G/1B00	T73KN1G/1L00	T73KN1G/1000	
1863T	16"	800	31.496	1	420	16.54	T73KJ1T/1F00	T73KJ1T/1E00	T73KJ1T/1C00	T73KJ1T/1B00	T73KJ1T/1L00	T73KJ1T/1000	
		1000	39.370	1	420	16.54	T73KJ1G/1F00	T73KJ1G/1E00	T73KJ1G/1C00	T73KJ1G/1B00	T73KJ1G/1L00	T73KJ1G/1000	
		300	11.811	1	50	1.97	T43KPA1Y/1F00	T43KPA1Y/1E00	T43KPA1Y/1C00	T43KPA1Y/1B00	T43KPA1Y/1L00	T43KPA1Y/1000	
1843T	1 1/4"	500	19.685	1	50	1.97	T43KPA1A/1F00	T43KPA1A/1E00	T43KPA1A/1C00	T43KPA1A/1B00	T43KPA1A/1L00	T43KPA1A/1000	
		250	9.843	1	100	3.94	T17KD1V/1F00	T17KD1V/1E00	T17KD1V/1C00	T17KD1V/1B00	T17KD1V/1L00	T17KD1V/1000	
1701T	53mm	500	19.685	1	100	3.94	T17KD1A/1F00	T17KD1A/1E00	T17KD1A/1C00	T17KD1A/1B00	T17KD1A/1L00	T17KD1A/1000	
		250	9.843	1	100	3.94	T17KD1V/1F00	T17KD1V/1E00	T17KD1V/1C00	T17KD1V/1B00	T17KD1V/1L00	T17KD1V/1000	

NOTE: for custom requests with dimensions different from the standard, please refer to page 323.

On request, TAB curves with dimensions different from the standard can be supplied.
Please fill the form below with the requested parameters and contact REGINA customer service.

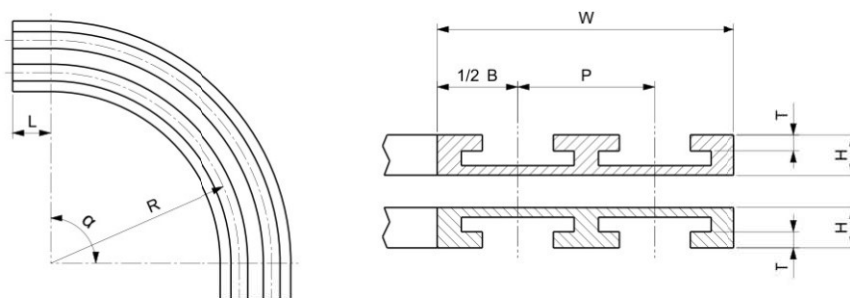



FOR CHAIN SERIES:	REQUESTED CURVE PARAMETERS		
CHAIN WIDTH:	mm	inch	°
FIRST RADIUS R:			
CURVE ANGLE α :			
N. OF TRACKS:			
TRANSVERSAL PITCH P:			
BASIC WIDTH B:			
TOTAL WIDTH W:			
INFEEED LENGTH L:			

For Matveyor® SIDEFLEXING BELTS

TAB curves for sideflexing belts include upper part only.

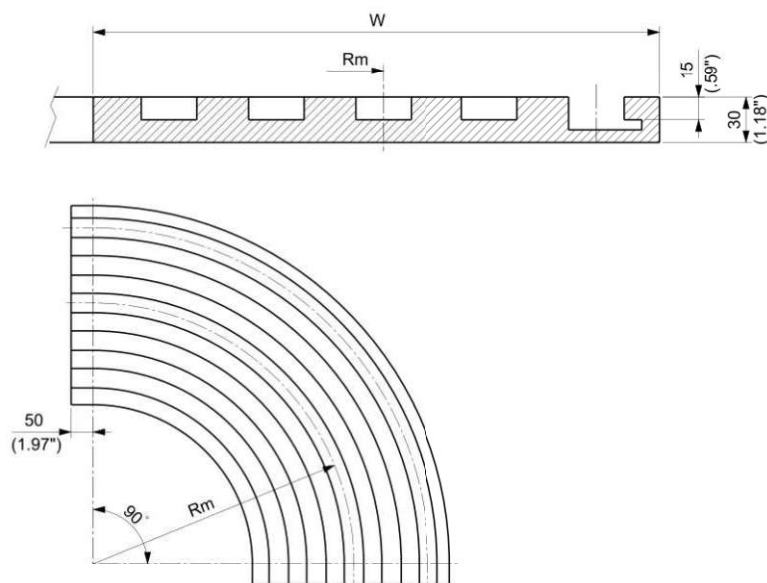
For more information on how to support the sideflexing belts in the return part, please contact REGINA application engineers.



The curves are manufactured in  material

 Curve material
see page 14

BELT TYPE	BELT WIDTH		MEDIUM RADIUS Rm		CURVE WIDTH W		PART NUMBER
	mm	inch	mm	inch	mm	inch	
2556HTB	255	10.039	600	23.622	281	11.063	T55HK0281/B10
	340	13.386	800	31.496	366	14.409	T55HK0366/C10
	425	16.732	1000	39.370	451	17.756	T55HK0451/D10
	510	20.079	1200	47.224	536	21.102	T55HK0536/E10
	595	23.425	1400	55.118	621	24.449	T55HK0621/F10
	680	26.772	1600	62.992	706	27.795	T55HK0706/G10
	765	30.118	1800	70.866	791	31.142	T55HK0791/H10
	850	33.465	2000	78.740	876	34.488	T55HK0876/J10
2556HTB-SR	340	13.386	500	19.685	366	14.409	T55HK0366/A10
	425	16.732	600	23.622	451	17.756	T55HK0451/B10
	510	20.079	800	31.496	536	21.102	T55HK0536/C10
	595	23.425	1000	39.370	621	24.449	T55HK0621/D10
	680	26.772	1200	47.224	706	27.795	T55HK0706/E10
	765	30.118	1400	55.118	791	31.142	T55HK0791/F10
	850	33.465	1600	62.992	876	34.488	T55HK0876/G10

For FliteTop® SIDEFLEXING CHAINS

Bevel curves include 3 parts: upper, return and support plate.

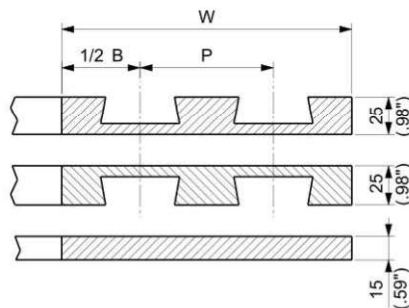
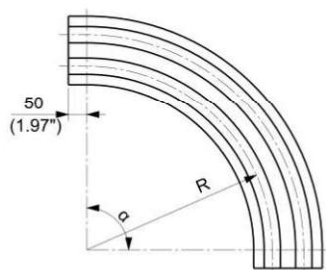

CHAIN WIDTH	TRANSVERSAL PITCH P		BASIC WIDTH B	
	mm	inch	mm	inch
3 1/4" 83.8 mm	85	3.35	100	3.94
4 1/2"	120	4.72	130	5.12
7 1/2"	195	7.68	200	7.87

On request, Upper part is available in Self-Lubricating UHMWPE & Oil-filled PA.



Curve material
see page 14

CURVES	PART NUMBER IDENTIFICATION		
	UHMWPE	NEW e-SLIDE	SUPREME-S
UPPER PART MATERIAL	UHMWPE	High performance Self-lubricating UHMWPE	Oil-filled PA
PART NUMBERS	See table below	Replace "B80" with "B80E" Example: Radius 500 mm, 1 track, 90° curve angle for 880 K 3/4 chain, P/N: B80EKD1A/1000	Replace "B80" with "B80P" Example: Radius 500 mm, 1 track, 90° curve angle for 880 K 3/4 chain, P/N: B80PKD1A/1000

CHAIN TYPE		RADIUS* R		N. OF TRACKS	TOTAL WIDTH W		PART NUMBER Curve angle α					
Series	Width	mm	inch		mm	inch	15°	30°	45°	60°	75°	90°
880 879 881 981	3 ¼" 83.8 mm	457,2	18	1	100	3.937	B80KD10/1F00	B80KD10/1E00	B80KD10/1C00	B80KD10/1B00	B80KD10/1L00	B80KD10/1000
				2	185	7.283	B80KD20/1F00	B80KD20/1E00	B80KD20/1C00	B80KD20/1B00	B80KD20/1L00	B80KD20/1000
				3	270	10.630	B80KD30/1F00	B80KD30/1E00	B80KD30/1C00	B80KD30/1B00	B80KD30/1L00	B80KD30/1000
				4	355	13.189	B80KD40/1F00	B80KD40/1E00	B80KD40/1C00	B80KD40/1B00	B80KD40/1L00	B80KD40/1000
				5	440	15.748	B80KD50/1F00	B80KD50/1E00	B80KD50/1C00	B80KD50/1B00	B80KD50/1L00	B80KD50/1000
		500	19.685	1	100	3.937	B80KD1A/1F00	B80KD1A/1E00	B80KD1A/1C00	B80KD1A/1B00	B80KD1A/1L00	B80KD1A/1000
				2	185	7.283	B80KD2A/1F00	B80KD2A/1E00	B80KD2A/1C00	B80KD2A/1B00	B80KD2A/1L00	B80KD2A/1000
				3	270	10.630	B80KD3A/1F00	B80KD3A/1E00	B80KD3A/1C00	B80KD3A/1B00	B80KD3A/1L00	B80KD3A/1000
				4	355	13.189	B80KD4A/1F00	B80KD4A/1E00	B80KD4A/1C00	B80KD4A/1B00	B80KD4A/1L00	B80KD4A/1000
				5	440	15.748	B80KD5A/1F00	B80KD5A/1E00	B80KD5A/1C00	B80KD5A/1B00	B80KD5A/1L00	B80KD5A/1000
		610	24.016	1	100	3.937	B80KD1C/1F00	B80KD1C/1E00	B80KD1C/1C00	B80KD1C/1B00	B80KD1C/1L00	B80KD1C/1000
				2	185	7.283	B80KD2C/1F00	B80KD2C/1E00	B80KD2C/1C00	B80KD2C/1B00	B80KD2C/1L00	B80KD2C/1000
				3	270	10.630	B80KD3C/1F00	B80KD3C/1E00	B80KD3C/1C00	B80KD3C/1B00	B80KD3C/1L00	B80KD3C/1000
				4	355	13.189	B80KD4C/1F00	B80KD4C/1E00	B80KD4C/1C00	B80KD4C/1B00	B80KD4C/1L00	B80KD4C/1000
				5	440	15.748	B80KD5C/1F00	B80KD5C/1E00	B80KD5C/1C00	B80KD5C/1B00	B80KD5C/1L00	B80KD5C/1000
	800	31.496		1	100	3.937	B80KD1T/1F00	B80KD1T/1E00	B80KD1T/1C00	B80KD1T/1B00	B80KD1T/1L00	B80KD1T/1000
				2	185	7.283	B80KD2T/1F00	B80KD2T/1E00	B80KD2T/1C00	B80KD2T/1B00	B80KD2T/1L00	B80KD2T/1000
				3	270	10.630	B80KD3T/1F00	B80KD3T/1E00	B80KD3T/1C00	B80KD3T/1B00	B80KD3T/1L00	B80KD3T/1000
				4	355	13.189	B80KD4T/1F00	B80KD4T/1E00	B80KD4T/1C00	B80KD4T/1B00	B80KD4T/1L00	B80KD4T/1000
				5	440	15.748	B80KD5T/1F00	B80KD5T/1E00	B80KD5T/1C00	B80KD5T/1B00	B80KD5T/1L00	B80KD5T/1000
				6	525	20.669	B80KD6T/1F00	B80KD6T/1E00	B80KD6T/1C00	B80KD6T/1B00	B80KD6T/1L00	B80KD6T/1000
		1000	39.370	1	100	3.937	B80KD1G/1F00	B80KD1G/1E00	B80KD1G/1C00	B80KD1G/1B00	B80KD1G/1L00	B80KD1G/1000
				2	185	7.283	B80KD2G/1F00	B80KD2G/1E00	B80KD2G/1C00	B80KD2G/1B00	B80KD2G/1L00	B80KD2G/1000
				3	270	10.630	B80KD3G/1F00	B80KD3G/1E00	B80KD3G/1C00	B80KD3G/1B00	B80KD3G/1L00	B80KD3G/1000
				4	355	13.189	B80KD4G/1F00	B80KD4G/1E00	B80KD4G/1C00	B80KD4G/1B00	B80KD4G/1L00	B80KD4G/1000
	610	24.016	1	130	5.118	B80KG1C/1F00	B80KG1C/1E00	B80KG1C/1C00	B80KG1C/1B00	B80KG1C/1L00	B80KG1C/1000	
			2	250	9.843	B80KG2C/1F00	B80KG2C/1E00	B80KG2C/1C00	B80KG2C/1B00	B80KG2C/1L00	B80KG2C/1000	
			1	130	5.118	B80KG1T/1F00	B80KG1T/1E00	B80KG1T/1C00	B80KG1T/1B00	B80KG1T/1L00	B80KG1T/1000	
			2	250	9.843	B80KG2T/1F00	B80KG2T/1E00	B80KG2T/1C00	B80KG2T/1B00	B80KG2T/1L00	B80KG2T/1000	
			1	130	5.118	B80KG1G/1F00	B80KG1G/1E00	B80KG1G/1C00	B80KG1G/1B00	B80KG1G/1L00	B80KG1G/1000	
			2	250	9.843	B80KG2G/1F00	B80KG2G/1E00	B80KG2G/1C00	B80KG2G/1B00	B80KG2G/1L00	B80KG2G/1000	
881 981	7 ½"	610	24.016	1	200	7.874	B80KL1C/1F00	B80KL1C/1E00	B80KL1C/1C00	B80KL1C/1B00	B80KL1C/1L00	B80KL1C/1000
				2	395	15.551	B80KL2C/1F00	B80KL2C/1E00	B80KL2C/1C00	B80KL2C/1B00	B80KL2C/1L00	B80KL2C/1000
		800	31.496	1	200	7.874	B80KL1T/1F00	B80KL1T/1E00	B80KL1T/1C00	B80KL1T/1B00	B80KL1T/1L00	B80KL1T/1000
				2	395	15.551	B80KL2T/1F00	B80KL2T/1E00	B80KL2T/1C00	B80KL2T/1B00	B80KL2T/1L00	B80KL2T/1000
		1000	39.370	1	200	7.874	B80KL1G/1F00	B80KL1G/1E00	B80KL1G/1C00	B80KL1G/1B00	B80KL1G/1L00	B80KL1G/1000
				2	395	15.551	B80KL2G/1F00	B80KL2G/1E00	B80KL2G/1C00	B80KL2G/1B00	B80KL2G/1L00	B80KL2G/1000

* First track is intended.

NOTE: for custom requests with dimensions different from the standard, please refer to page 327.

For FliteTop® SIDEFLEXING CHAINS

Bevel curves include 3 parts: upper, return and support plate.

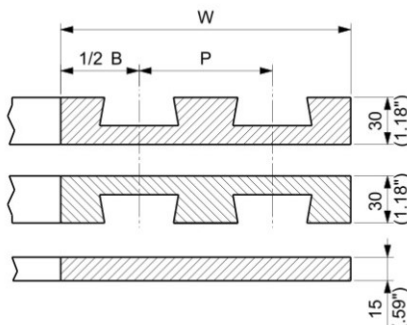
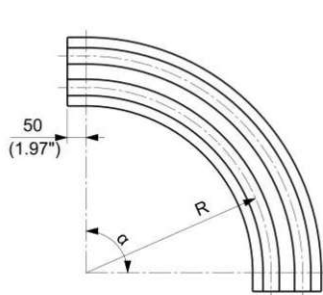

CHAIN WIDTH	TRANSVERSAL PITCH P		BASIC WIDTH B	
			mm	inch
4 1/2"	Single track		130	5.12
7 1/2"			200	7.87
10"			270	10.63
12"			320	12.60

On request, Upper part is available in Self-Lubricating UHMWPE & Oil-filled PA.



CURVES	PART NUMBER IDENTIFICATION		
	UHMWPE	NEW e-SLIDE	SUPREME -S
UPPER PART MATERIAL	UHMWPE	High performance Self-lubricating UHMWPE	Oil-filled PA
PART NUMBERS	See table below	Replace "B82" with "B82E" Example: Radius 610 mm, 1 tracks, 90° curve angle for 882 K 4 1/2 chain, P/N: B82EKG1C/1000	Replace "B82" with "B82P" Example: Radius 610 mm, 1 tracks, 90° curve angle for 882 K 4 1/2 chain, P/N: B82PKG1C/1000



Curve material see page 14

CHAIN TYPE		RADIUS R		N. OF TRACKS	TOTAL WIDTH W		PART NUMBER					
Series	Width	mm	inch		mm	inch	Curve angle alpha					
882	4 1/2"	610	24.016	1	130	5.118	B82KG1C/1F00	B82KG1C/1E00	B82KG1C/1C00	B82KG1C/1B00	B82KG1C/1L00	B82KG1C/1000
		800	31.496	1	130	5.118	B82KG1T/1F00	B82KG1T/1E00	B82KG1T/1C00	B82KG1T/1B00	B82KG1T/1L00	B82KG1T/1000
		1000	39.370	1	130	5.118	B82KG1G/1F00	B82KG1G/1E00	B82KG1G/1C00	B82KG1G/1B00	B82KG1G/1L00	B82KG1G/1000
	7 1/2"	610	24.016	1	200	7.874	B82KL1C/1F00	B82KL1C/1E00	B82KL1C/1C00	B82KL1C/1B00	B82KL1C/1L00	B82KL1C/1000
		800	31.496	1	200	7.874	B82KL1T/1F00	B82KL1T/1E00	B82KL1T/1C00	B82KL1T/1B00	B82KL1T/1L00	B82KL1T/1000
		1000	39.370	1	200	7.874	B82KL1G/1F00	B82KL1G/1E00	B82KL1G/1C00	B82KL1G/1B00	B82KL1G/1L00	B82KL1G/1000
	10"	610	24.016	1	270	10.630	B82KM1C/1F00	B82KM1C/1E00	B82KM1C/1C00	B82KM1C/1B00	B82KM1C/1L00	B82KM1C/1000
		800	31.496	1	270	10.630	B82KM1T/1F00	B82KM1T/1E00	B82KM1T/1C00	B82KM1T/1B00	B82KM1T/1L00	B82KM1T/1000
		1000	39.370	1	270	10.630	B82KM1G/1F00	B82KM1G/1E00	B82KM1G/1C00	B82KM1G/1B00	B82KM1G/1L00	B82KM1G/1000
	12"	610	24.016	1	320	12.598	B82KN1C/1F00	B82KN1C/1E00	B82KN1C/1C00	B82KN1C/1B00	B82KN1C/1L00	B82KN1C/1000
		800	31.496	1	320	12.598	B82KN1T/1F00	B82KN1T/1E00	B82KN1T/1C00	B82KN1T/1B00	B82KN1T/1L00	B82KN1T/1000
		1000	39.370	1	320	12.598	B82KN1G/1F00	B82KN1G/1E00	B82KN1G/1C00	B82KN1G/1B00	B82KN1G/1L00	B82KN1G/1000

NOTE: for custom requests with dimensions different from the standard, please refer to page 327.

On request, BEVEL curves with dimensions different from the standard can be supplied.
Please fill the form below with the requested parameters and contact REGINA customer service.

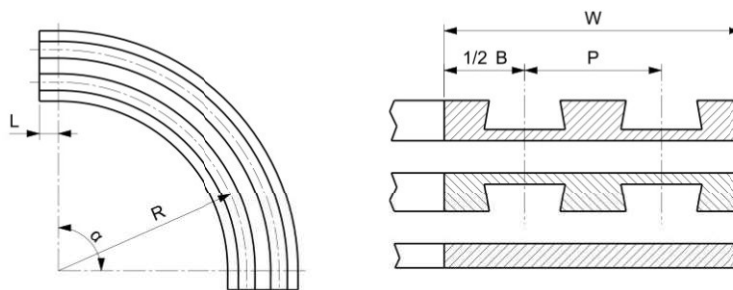

FOR CHAIN SERIES:	REQUESTED CURVE PARAMETERS		
CHAIN WIDTH:	mm	inch	°
FIRST RADIUS R:			
CURVE ANGLE α :			
N. OF TRACKS:			
TRANSVERSAL PITCH P:			
BASIC WIDTH B:			
TOTAL WIDTH W:			
INFEEED LENGTH L:			

For Matveyor® SIDEFLEXING CHAINS

Low Pin Center curves include both upper and return parts.

CHAIN WIDTH	TRANSVERSAL PITCH P		BASIC WIDTH B		INFEED/OUTFEED LENGHT	
	mm	inch	mm	inch	mm	inch
4 1/2"	116	4.57	125	5.92	-	-

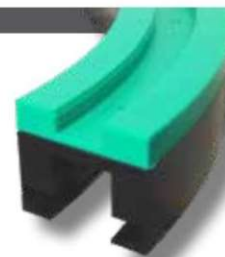

Single track

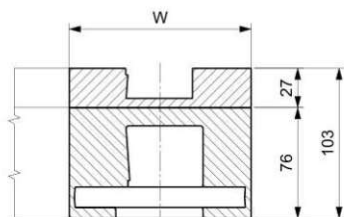

Multi track

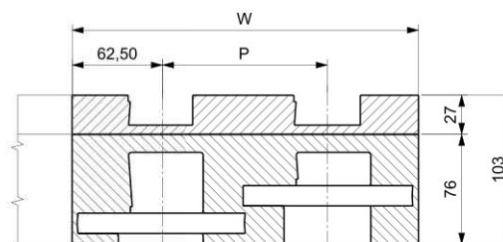

Radius

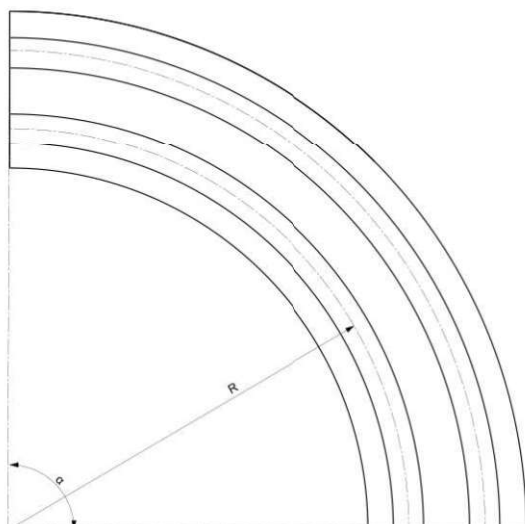

On request, Upper part is available in Self-Lubricating UHMWPE & Oil-filled PA.



Curve material see page 14

CURVES	PART NUMBER IDENTIFICATION		
	SUPREME -A	NEW e-SLIDE	SUPREME -S
UPPER PART MATERIAL	UHMWPE	High performance Self-lubricating UHMWPE	Oil-filled PA
PART NUMBERS	See table below	Replace "L93" with "L93E" Example: Radius 610 mm, 1 track, 90° curve angle, P/N: L93KGC1C/0000	Replace "L93" with "L93P" Example: Radius 610 mm, 1 track, 90° curve angle, P/N: L93PKGC1C/0000

CHAIN TYPE		RADIUS* R		N. OF TRACKS	TOTAL WIDTH W		PART NUMBER							
Series	Width	mm	inch		mm	inch	Curve angle alpha							
793L	4 1/2"	610	24.02	1	125	4.92	L93KGC1C/0F00	L93KGC1C/0E00	L93KGC1C/0C00	L93KGC1C/0B00	L93KGC1C/0L00	L93KGC1C/0000		
				2	241	9.49	L93KGC2C/0F80	L93KGC2C/0E80	L93KGC2C/0C80	L93KGC2C/0B80	L93KGC2C/0L80	L93KGC2C/0080		
				3	357	14.06	L93KGC3C/0F80	L93KGC3C/0E80	L93KGC3C/0C80	L93KGC3C/0B80	L93KGC3C/0L80	L93KGC3C/0080		
				4	473	18.62	L93KGC4C/0F80	L93KGC4C/0E80	L93KGC4C/0C80	L93KGC4C/0B80	L93KGC4C/0L80	L93KGC4C/0080		
				5	589	23.19	L93KGC5C/0F80	L93KGC5C/0E80	L93KGC5C/0C80	L93KGC5C/0B80	L93KGC5C/0L80	L93KGC5C/0080		

* First track is intended.

NOTE: for custom requests with dimensions different from the standard, please refer to page 329.

On request, Low Pin Center curves with dimensions different from the standard can be supplied.
Please fill the form below with the requested parameters and contact REGINA customer service.

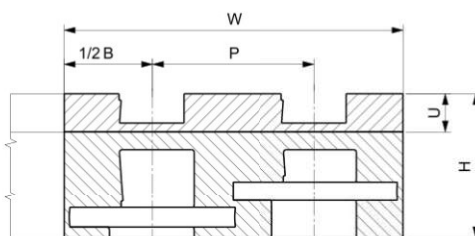
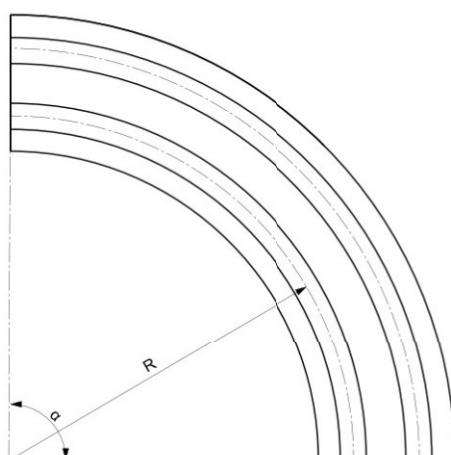
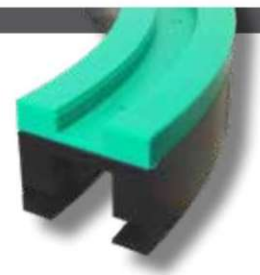

FOR CHAIN SERIES:	REQUESTED CURVE PARAMETERS		
CHAIN WIDTH:	mm	inch	°
FIRST RADIUS R:			
CURVE ANGLE α :			
N. OF TRACKS:			
TRANSVERSAL PITCH P:			
BASIC WIDTH B:			
TOTAL WIDTH W:			
INFEEED LENGTH L:			